

Who we are?

- **Tekmart International Limited**

is a private Capital Canadian Plastic Molding Company that operates as a TIMS Mexico in Ciudad Juarez and Tijuana. Supporting industrial sectors such as Automotive, Home Appliances, Recreational Vehicles (ATV) & Electronics.



Why TIMS

- Molding Experience +20 years
- Tool Design expertise /Certified tool makers
- Program management for new tools.
- ISO9000, IATF, ISO14000, IMMEX , CTPAT Certifications
- Safety Stock as per your requirements
- Technical capabilities for tool and new product management, DFM, Mold Flow, PPAP , APQP, Core Tools.
- Fast response to customers
- Good customer relationship



Key Capabilities

- We offer injection molding presses from 50 ton up to 2,400 tons for large and complex plastic parts.
- Parts weight up to 10 kg in volume.
- Advanced metrology lab: CMM, mechanical testing and more.
- In-house mold maintenance and engineering change capabilities.
- We mold complex geometries with Class A surfaces for High gloss and Grained products.
- Expertise in producing clear cosmetic parts
- Manufacturing Light housing products, thick lens and light guides products up to 2 meters in length.

Company Snapshot

Financially Stable

- Consistently growing since 2013.
- Weathered challenges in 2019-2023
- Financially stable

Business Diversification

- 30% Automotive*
- 30% Appliances
- 30% Recreational Vehicles (ATV), Electronics
- 10% Communications & Non-Invasive Medical

Long Term relationship

- OEMS' and Tier One
- Healthy business distribution
- New 5-year programs 2030

Expansion

- New Plants in TJ and Juarez
- Acquired Power-Sonic Tijuana 2022 & Brenta in 2020 Juarez
- New Facility in Juarez 2025

TIMS Numbers

2 Facilities
Juarez &
Tijuana



IMM
+57



Over 400
employees



MOLDS
350



2 WAREHOUSE
EL PASO, TX
SAN DIEGO, CA



2 Tool Shop
Insite



+15 Resins:
PS,PP ABS,PA,PBT,
PC/ABS,POM, etc..



+15
Customers



TIMS Facilities

- Juarez main plant 100K SQF Texas Border
Calle Fulton 851, Parque Industrial Antonio J. Bermudez, 32470 Juárez, Chih.
- Tijuana plant 60K SQF San Diego border
Calle 9 Sur 1510, Ciudad Industrial, 22444 Tijuana, Baja California



New Plant In Juarez

851 Calle Fulton Parque Ind. Antonio J. Bermúdez Ciudad Juarez

Building Power: 4,500 kVA

200 Ton Central Cooling System

Central Material Handling

Silos, Blending & Grinding

Plant Support Equipment: Forklifts, Loading Docks, Conveyors, etc.

Tool shop



- ✓ 30 IMM 100 to 2400 Tons
- ✓ Crane
- ✓ Assembly area
- ✓ Secondary operations

10 Minutes from El Paso border easy access for trucks, newly built, class A building.



TIMS Capabilities Jrz/Tj

Injection Molding & Assy

- ✓ Large parts
- ✓ Insert/Over molding
- ✓ Pad Printing
- ✓ Hot stamping
- ✓ Ultrasonic welding
- ✓ Gas assist Molds

Tool build design management

- ✓ In house Design
- ✓ Project Management
- ✓ DFM & MOLD Flow
- ✓ China Eng. Office
- ✓ In house tool room for maintenance assembly and reworks

Metrology Lab Tool Room

- ✓ CMM
- ✓ Color, Gloss, Harmony measuring
- ✓ Laser scanning
- ✓ Packaging validation
- ✓ Rapid ECR

Certification : IATF16949, ISO9000, ISO14000, CTPAT,

Over 57 Injection molding machines. between 50T to 2400T. (open capacity)



TIMS Injection Machines

Plant IMM/Ton	50-300	400-600	700-900	1000-1200	1300-1600	2000-2400	Total
Juarez	7	16	3	3	1	1	31
Tijuana	12	9	1	1	1	2	26
						Total	57



Tool Room

Preventive & Corrective Maintenance

First Level - maintenance at machine level according of shots, cleaning, visual inspection of inserts, movable parts and venting.

Second Level – change coils, Inserts, bushings, and O’rings

Corrective Maintenance - ability to make correction and tool improvements.

Engineering Changes - Ability to analyze and prepare feasibility reports & propose ECR.

Tool Room Machineries

- Wire EDM, EDM Machine, CNC, Milling machines.
- Air cranes with capacity up to 25 Tons.
- Lazer, Tig, and Micro welding.
- Heat treatment and hardness tester.
- Lathe
- Grinding Machine
- Die setting machine



DFM & Mold Flow Analysis

DFM Details:

- Part information (3D & 2D)
- General information
- Mold Layout
- Parting line
- Injection System
- Ejection system
- Core sub Inserts
- Cavity sub inserts
- Sliders & lifters (if have)
- Draft analysis
- Thickness analysis
- Core side cooling
- Cavity side cooling
- Slider/lifter cooling (if have)
- Weak steel information
- Engraving
- Part surface finish
- Part pick up
- Standards
- DFM intent

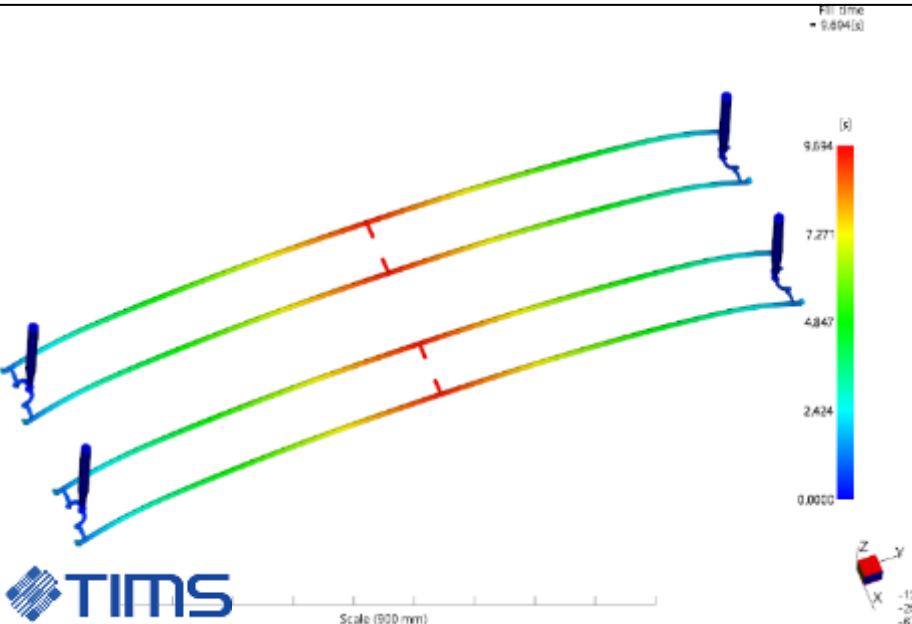
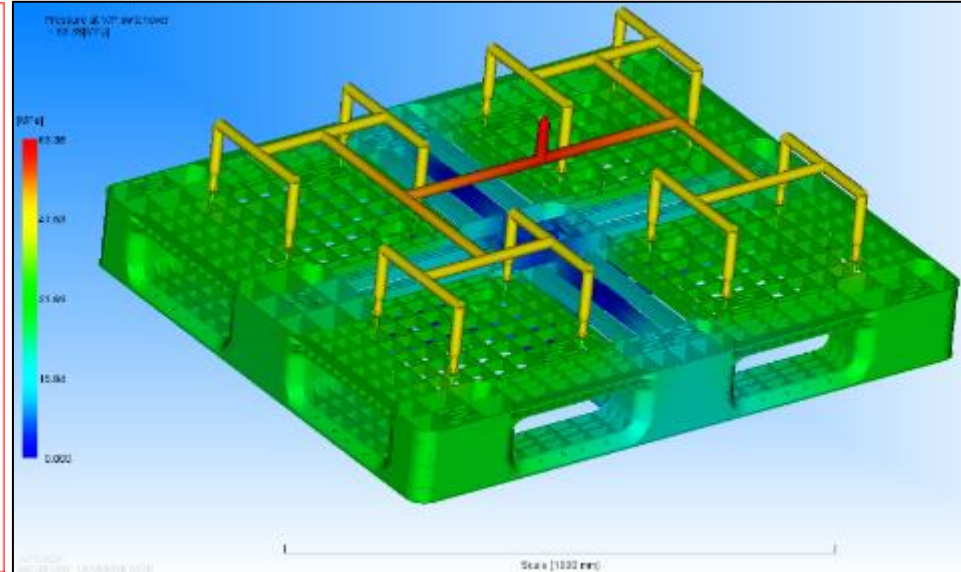
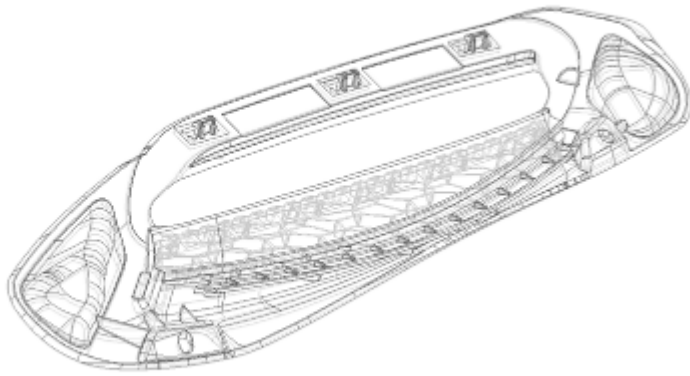

Assembly & Sub-Assembly

Assembly and sub-assembly of component parts:

- Performing inspections
- Fastening
- Functional tests
- Labeling
- Quality control
- Packaging
- Preparation for final use

Secondary operations

Pad printing - Heat transfer - Hot stamping

Ultrasonic welding - Vibration welding

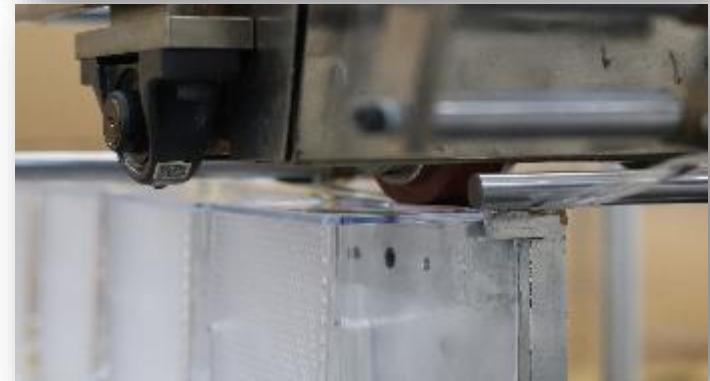

Quality Systems

Process Control.

APQP, PPAP, FMEAS, CP, SPC, IQ, OQ,
PQ Validations Protocols for Medical industry.

Document and Data Control.

ISO/9000 – IATF - 16949 /VDA

Quality and Metrology Lab – Fully equipped

- Heat deflection load (HDT)
- VICAT softening temperature (VSP)
- Melt Flow Index
- Tensile strength
- Resistance Test
- Torsion Test
- Flexion-torsion Test
- Impact Test
- Flammability Test
- Dimensional Metrology
- Roughness surface
- Spectrophotometer (color and appearance)

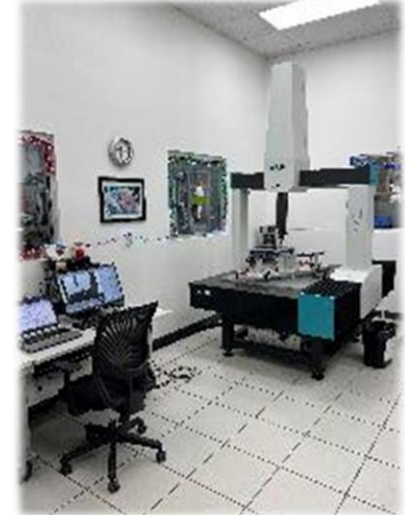
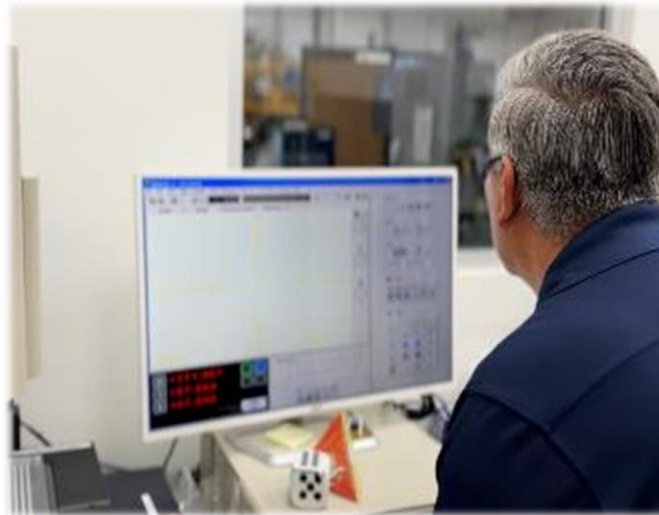

TIMS Customers



Amphenol



flex



LUCID

JABIL

stryker



COMMSCOPE®



Light Guides



Light Guide (1.3 m)
580 Tons

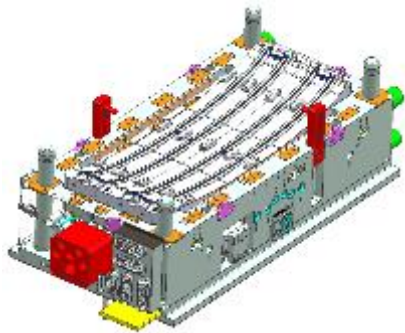
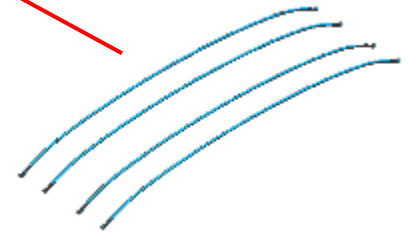

Light Guides

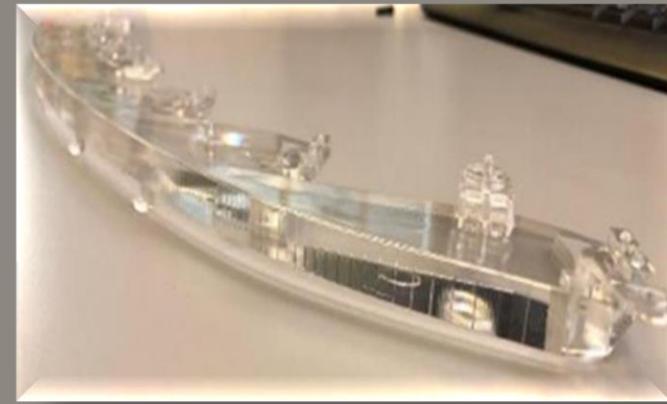

JEEP COMPASS 2021 HL Blade – Production in TIMS-3

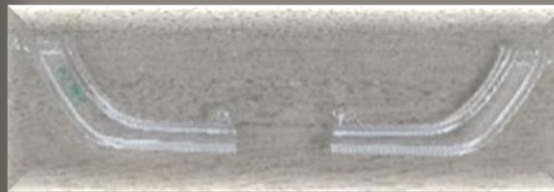
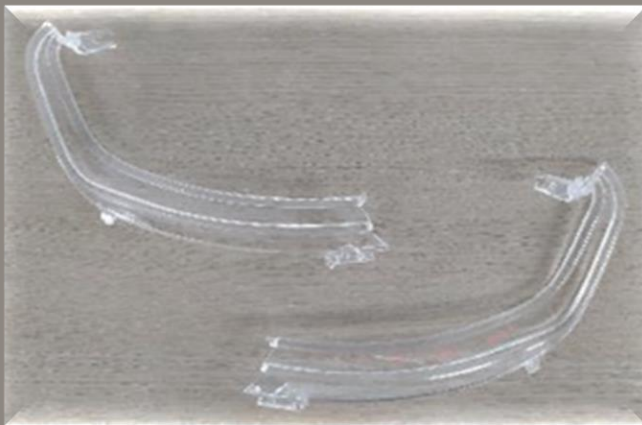

**JEEP COMPASS 2021 HL Light guide and Inner Lenses RL
Light Guides 550 Tons**



Light Guides

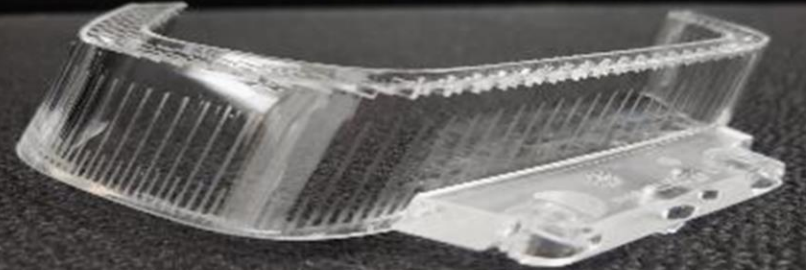

Recreational Vehicles

Maverick R Max X RS
(Sport Roof) 2,400 Tons



Car Interior Parts



TESLA



Car Interior Parts

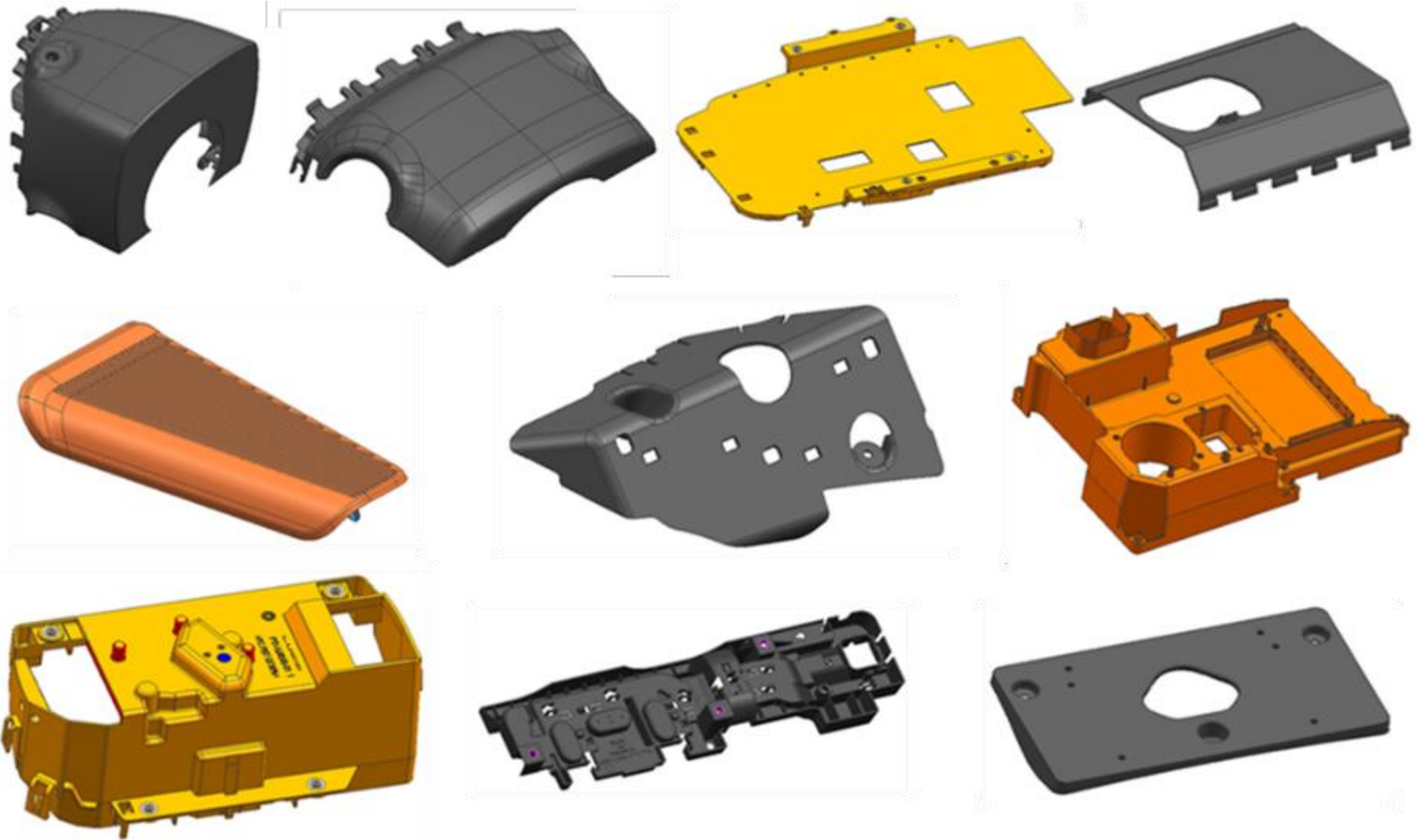

LUCID



Car Interior Parts

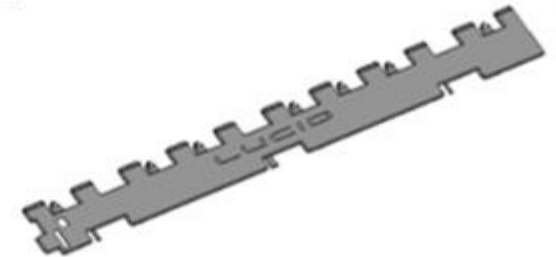
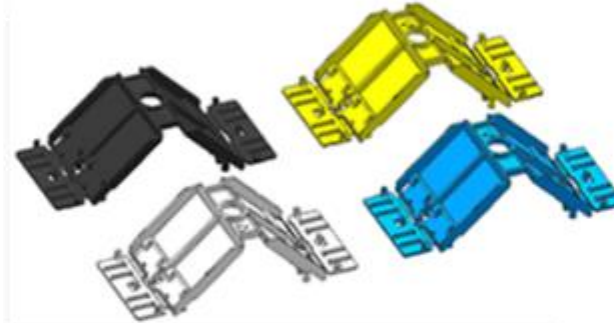
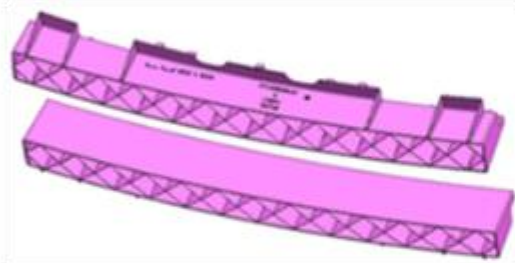

LUCID

TIMS

Home Appliances



Communications



Non-Invasive Medical

ICU Critical Care Bed

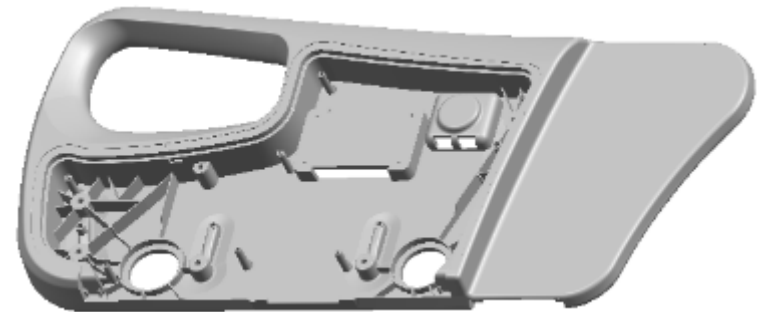
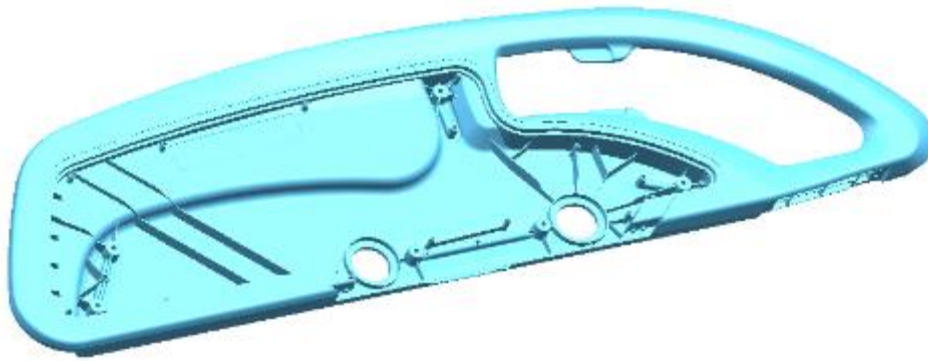

Mould Running in 1500-2400 Ton Machines



Gas Assist Molding Products

Part Size: 1198 x 320 x 49.5



Nitrogen Gas Travelling area

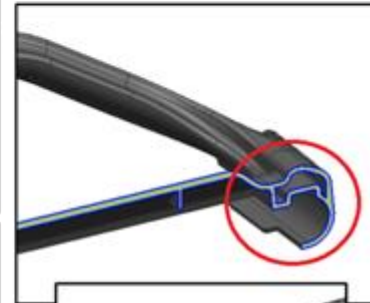
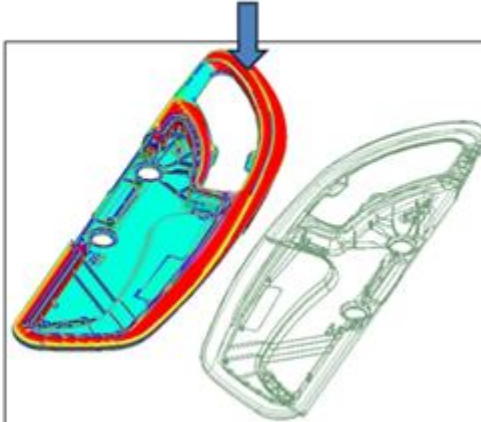

Part Size: 917 x 425 x 75

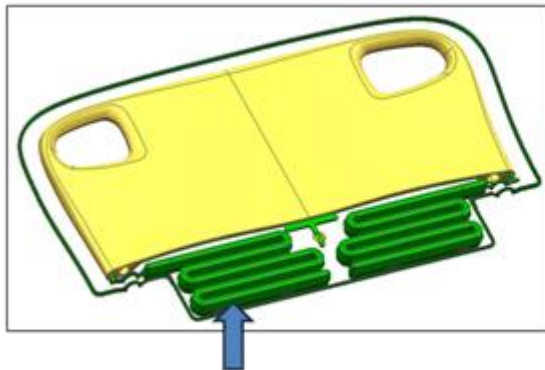

Over Flow Design

Nitrogen Gas Travelling area

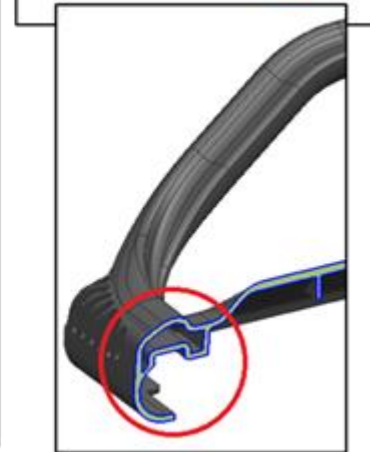
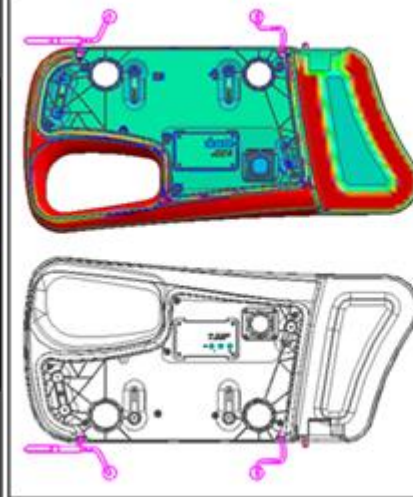
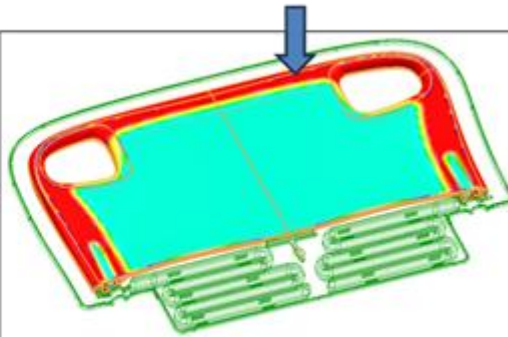

TIMS Contact Information

Contact us to learn more about manufacturing possibilities.

Thank you!

Bernardo Castro
/Sales/Engineering Manager
bernardo.castro@tekmartims.com
+52 656-379-1167
+1 915 307-9103

Jose Gonzalez/ E-Marketing/Sales
Jose.Gonzalez@tekmartims.com
+1 915-503-2803
+52 656-644-7830

**Luis Medina /Business Development
Manager**
luis.medina@tekmartims.com
+52 664-666-3134

sales@tekmartims.com

<http://www.tekmartims.com/>



@TIMSMEXICO