



# SERVICIOS GENERALES DE MANUFACTURA

La Solución a sus Necesidades



## MISSION.

Offer the best services to our customers, exceeding their expectations through innovative solutions and applying engineering, guaranteeing total quality in the needs that arise in a timely manner.

## VISION.

To be a leading service company in the application of engineering and solutions according to the needs of the market through the adaptation of technologies.

## VALUES.

We are a company 100% responsible in providing first level attention to our customers, dedicated to offering quality excellence in our projects, professionals in the elaboration of each work and focused on continuous innovation and delivering our products and services on time, with quality, complying with specifications and promoting new technologies and improvements giving support 24 x 7.

# SERVICES

## Design and Manufacture of Tooling and Injection Molds

- Precision machining
- Major repair
- Manufacture of spare parts
- Mass production of machined parts
- Reverse engineering
- Stamping maquila up to 300 tons

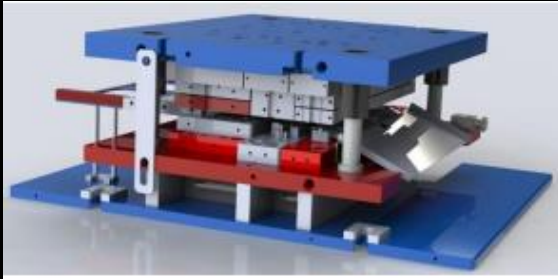

## Engineering and Design Automation

- Manufacture and integration of equipment for manufacturing, inspection and assembly
- Turnkey projects
- Welding
- Design of drawings and mechanisms
- Electronic design
- Reverse engineering

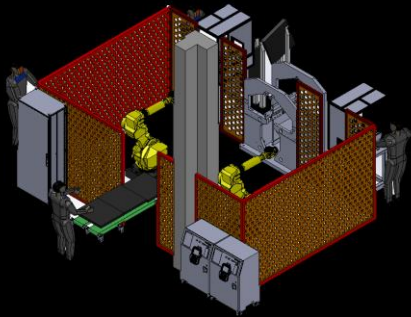

## Aluminum Injection - Die Casting

- Aluminium / Zamak
- Surface termination
- Machining
- Assemblies and tests



# SERVICES



## Sheet Metal & Stamping

- Laser Machine
- CNC Turret Punching
- Rod Stamping
- Forming
- Rod / Tube Laser Cut
- Welding
- Powder Coating Paint



## Thermoforming

- Develop and manufacture own models
- CNC Router machines
- Thermoform machines



## Maquinado

- Machining Centers
- Turning Centers
- Conventional Machines
- Welding

### SHEET METAL

Company with experience within the metalworking industry, seeking its national and international positioning through a service adapted to each of the demands of our clients making of every project more than a goal a priority.



### TECHNOLOGY IN THERMOFORMING



We are a company specialized in the thermoforming industry. We have solutions to your needs, giving our vast experience in the field. Our products are of the best quality, and we have the best and most qualified supplies of plastics in the country. Thanks to our capacity, experience and infrastructure, we have the firm commitment to be come the most preferred Company in the field of plastics.

### MACHINING



We are a Tier 2 company, dedicated to the manufacture of components for the industry at a global level, with more than 20 years of in the market, in order to provide a service with the highest standards of quality, always being committed to provide our work with the necessary haste and with the best quality in materials and labor, using specialized personnel, equipment and the appropriate tool for its manufacture. Since our processes range from design, machining, roll cutting, laser cutting, water cutting, welding assembly, mechanical assembly, spray paint coatings, powder painting or e-coat painting. We serve industries such as: automotive, energy, white goods, electronics, food, oil.





**GRACIAS!!!**

Juan Carlos Estrada R.  
81 8210 5423  
[jcestradar@outlook.com](mailto:jcestradar@outlook.com)

# Design and Manufacture of Stamping Tooling and Injection Molds

Company specialized in the design and manufacture of tooling with Japanese engineering.

We provide high level engineering and agility in the problem solving for high complexity projects

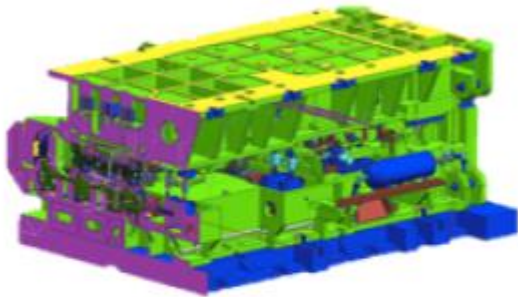

**DESIGN**

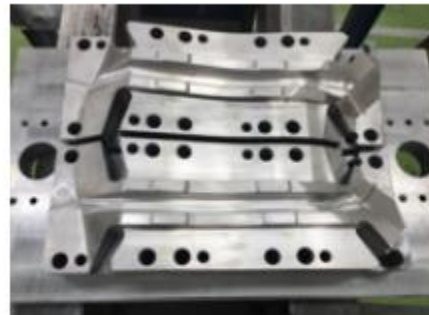

**DIE MANUFACTURING**



**REVERSE ENGINEERING**

Manufacturing, maintenance and set-up of tooling, as well as soft tools and checking fixtures.

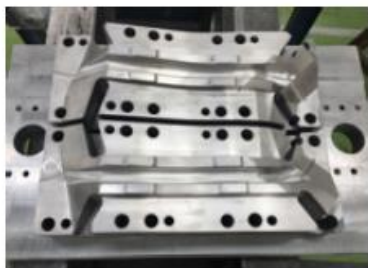

## MANUFACTURING AND MAINTENANCE



## PRECISION MACHINING WITH SPECIALIZED EQUIPMENT

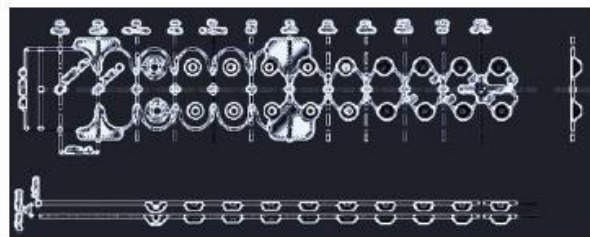

## FOCUS ON PROCESS OPTIMIZATION

# SERVICES

## FAST PROTOTYPES

Quick simple soft tool design and manufacturing for low volume or first prototype parts.

## REVERSE ENGINEERING



Parts with cracks, welding, surface wear or damage to their cutting on edges.

Solid 3D data after repairing surfaces according to the function of the part.

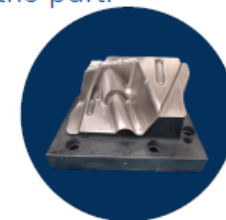

Optical scanner equipment for reverse engineering and 3D inspection with high accuracy,  $\pm 0.002\text{mm}$  in a single 3D scan, and high resolution with working distance of 440mm.

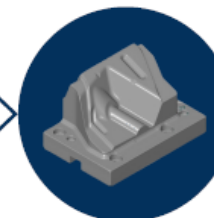
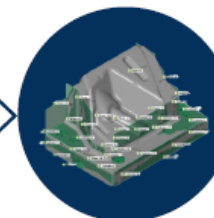

# EQUIPMENT

- HIGH ACCURACY EQUIPMENT -



EDM wire cutting machinery with accuracy of  $\pm 0.001\text{mm}$ , from 2D or 3D geometry. It can cut materials up to 200mm in height

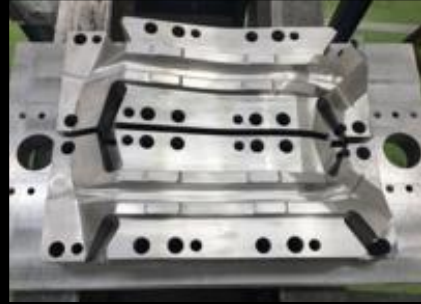

3-axis CNC machinery for surfaces with high quality finishes. Cad cam programming with process optimization software.



CNC lathe with 2 axes for parts such as guide pins, bushings, pilots and punches, from cam programming in 2D and 3D.



Optical scanner equipment for reverse engineering and 3D inspection with high accuracy,  $\pm 0.002\text{mm}$  in a single 3D scan, and high resolution with working distance of 440mm.



# EQUIPMENT

- HIGH ACCURACY EQUIPMENT -



## EQUIPMENT

HYDRAULIC PRESS FOR TRY OUTS  
BRAND · SAVAGE

### Specifications (All inches)

Tonnage Capacity

100 tons

Stroke

74" (1879.6mm)

Daylight

124" (3149.6mm)

Shut height

50" (1270mm)

Press speeds

Advance-120ipm (3048mm p/m)  
Press- 0 to 20" ipm (0 to 508mm p/m)  
Retract - 190ipm (4286mm p/m)

Platen size

120" (3048mm) left to right, between post-  
84" (2133.6mm) front o back overall

# PRESS STAMPING AND PRODUCT MANUFACTURING



DIE STAMPING FROM 150 TO 300 TONS



DIE MAINTENANCE



3D SCANNING MEASUREMENT





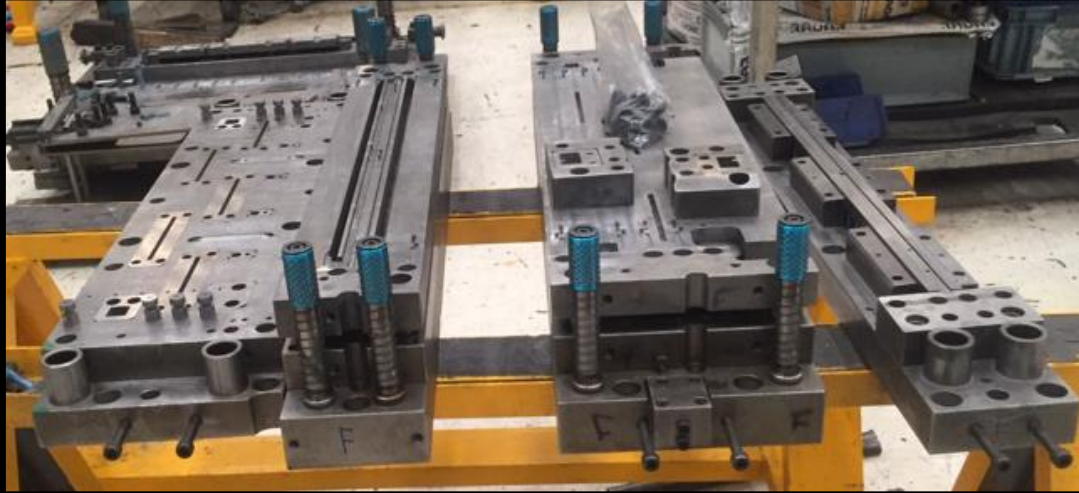



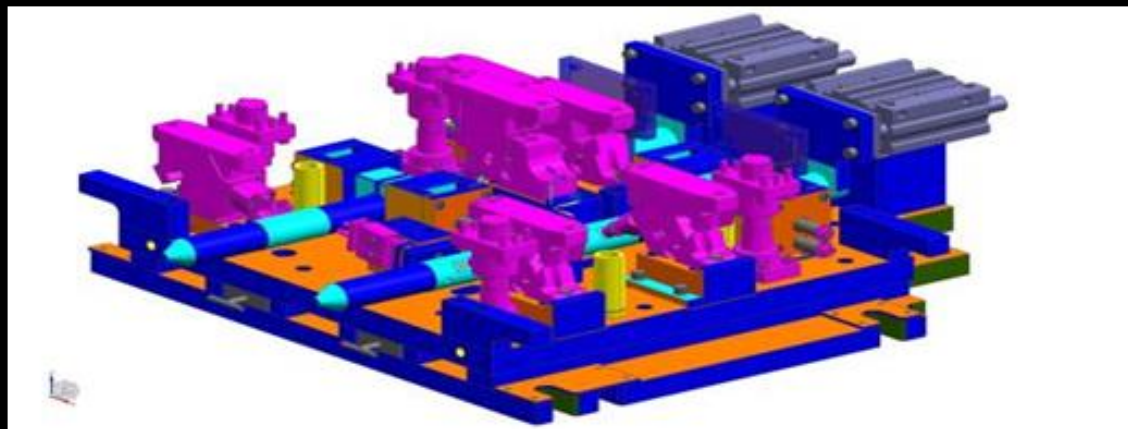
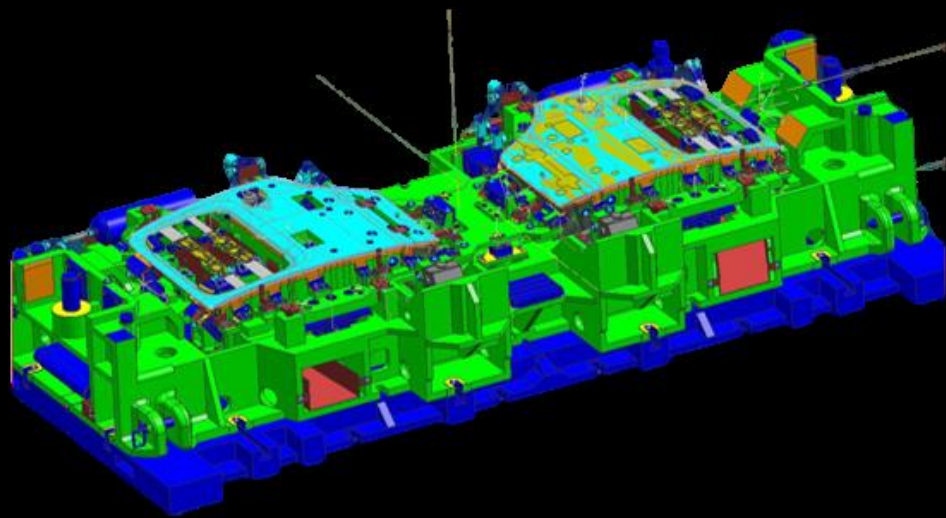



## OUR CLIENTS



### SERVICES



**Design and Manufacture of Tooling and Injection Molds**

- Precision machining
- Mold repair
- Manufacture of spare parts
- Mass production of machined parts
- Reverse engineering
- Stamping molds up to 300 tons

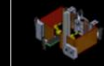

**Engineering and Design Automation**

- Manufacture and integration of equipment for manufacturing, inspection and assembly
- Turnkey projects
- Welding
- Design of drawings and mechanisms
- Electronic design
- Reverse engineering



**Aluminum Injection - Die Casting**

- Aluminum / Zamak
- Surface treatment
- Machining
- Assemblies and tests

# ENGINEERING AND DESIGN AUTOMATION

## Products and services

- Automation and Control
- Design and manufacture of special equipment
- Installation and electromechanical assemblies
- Reconstruction and upgrading of equipment
- Staffing –Project Engineers, Designers, Programmers, Electrical and Mechanical staff
- Safety –Risk Assessment, Orientation and consulting, equipment validation
- Safety introductory and advanced training
- DC3 training

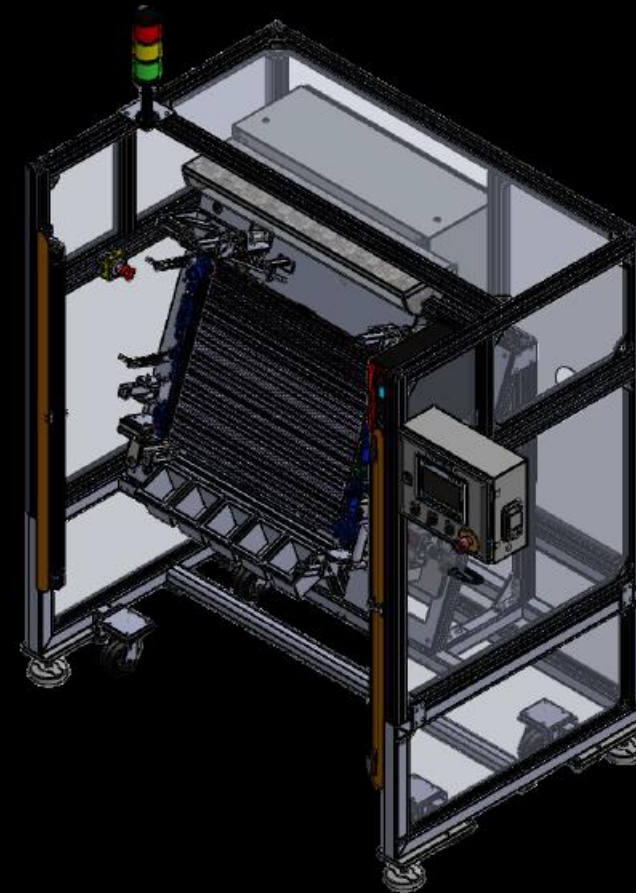

## Skills

System design and 3D simulation.

- Design, programming and simulation of robotic cells & CNC machines.
- Design and construction of tools and fixtures.
- Programming software and electrical controls.
- Reverse engineering.
- Special Machining workshop.
- Equipment for installations and assembly.





Before



After



**Rockwell**  
**Automation**  
 **Allen-Bradley**

**DENSO**  
**robotics**

  
**SOLIDWORKS**

PARTNER  
SYSTEM  
INTEGRATOR   
**COGNEX**

## Certifications



**Mitsubishi Electric**  
**System Integrator**

  
**UNIVERSAL ROBOTS**



Ovens



Vision System



Punching Machine



Manipulator lift assist

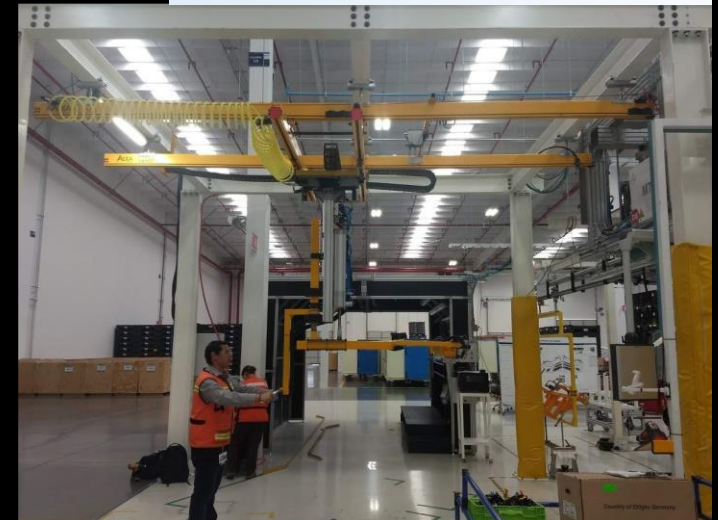



**Robot adhesive application System**



**Robotic Cells**



**SERVICES**

**Design and Manufacture of Tooling and Injection Molds**

- Precision machining
- Major repair
- Manufacture of spare parts
- Mass production of machined parts
- Reverse engineering
- Blowing moulds up to 200 tons

**Engineering and Design Automation**

- Manufacture and integration of equipment for manufacturing, inspection and assembly
- Turnkey projects
- Welding
- Design of drawings and mechanisms
- Electronic design
- Reverse engineering

**Aluminium Injection - Die Casting**

- Aluminium / Zamac
- Surface treatment
- Machining
- Assemblies and tests



Customers





# Die Casting

We are a company dedicated to the manufacture of Aluminum die cast parts, complemented by secondary operations required by our customers: trimming debarring, surfaces finishing, Machining processes as drilling and tapping; assembly and tests.





## MARKETS:

- INDUSTRIAL
- ELECTRICAL
- STRUCTURAL
- DOMESTIC AND FARM



# QUALITY ASSURANCE

- Certificated Alloys
- Improvement quality control based on ISO 9001-2015
- In process - 100% visual inspection system
- Destructive test to internal probe ( in sampling)
- Measuring of finished parts (Gauges, micrometer, Vernier)



## Die casting machines

Maquina	tonelaje	Marca	distancia entre barras eje X	dist entre barras y	Altura mínima	altura máxima	posición de inyección
120-1	120 ton	italpresse	360 mm	360 mm	140 mm	420 mm	central e inferior (80 mm bajo centro )
250-1	250 ton	Bulher	500mm	550mm	200 mm	700 mm	central e inferior 150 mm debajo centro)
500-1	500 ton	Bulher	620 mm	680 mm	250 mm	700 mm	central e inferior 200 mm bajo centro)
750-1	750 ton	Kux	715 mm	715 mm	500 mm	900 mm	Inferior 200 bajo centro

## Machinned machines

Maquina	Marca	dimensiones X-Y-Z
CNC-1 CENTRO DE MAQUINADO	ACROLOC	50"-18"-9"
F-1 FRESADORA	BRIDGEPORT	775-400-406mm
F-2 FRESADORA	ALLIANT	775-400-406mm
TORNO	DJC	500mm de volteo por 2000mm de longitud



# CUSTOMERS:

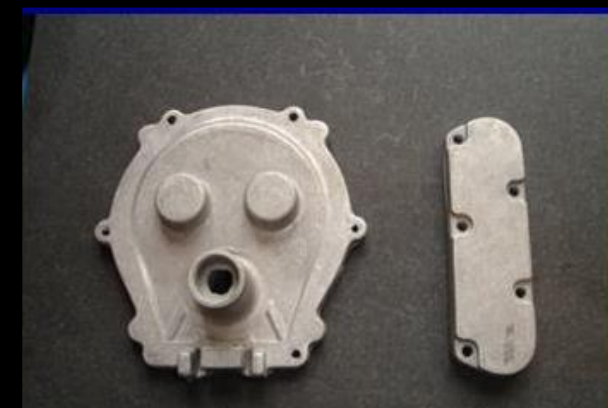



## SHEET METAL

Company with experience within the metalworking industry, seeking its national and international positioning through a service adapted to each of the demands of our clients making of every project more than a goal a priority.

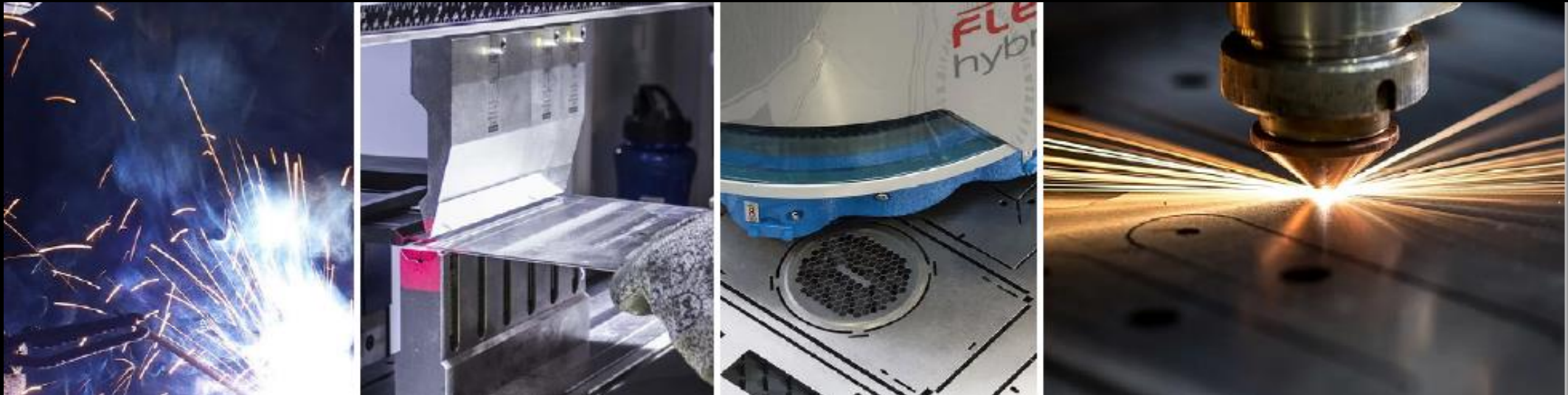

# SERVICES



## LASER CUT

Fiber Optic Laser Cutting.  
Bed with 1500mm X 3000mm travels.  
Carbon Steel : Cut up to 16 mm.  
Stainless Steel : Cut up to 8 mm.  
Aluminum : Cut up to 8 mm.



## CNC TURRET PUNCHING

Worktable with 1250 mm X 2500 mm  
Maximum punching force equivalent to 30 ton.  
Carbon steel: punching from cal. 30 to cal. 3  
Stainless Steel : punching form cal. 30 to cal. 11  
Aluminum : punching



## ROD STAMPING

We offer a rod stamping service, wich is adjusted to the needs of the client and the realization of quick jobs.

Stamping press of:

15 Ton.  
20 Ton.  
40 Ton.



# SERVICES



## FORMING

Our last generation forming equipment has the following capabilities to carry out deformations on steel sheet or plate.

Effective bending length = 3100 mm.  
Maximum tonnage of 220.



## ROD / TUBE LASER CUT

We have the necessary experience and resources to be able to carry out work under the highest standards of quality and demand. Taking our first steps within the metalworking industry in this area, we can guarantee that the desired service will meet all requirements.

Maximum cutting range (mm):      Cut dimensions in bundles:

D 320  
W 320 X H320

Maximum (mm): W290 X H140  
Minimum (mm): W220 X H90



## WELDING

More than a service, at ACERGMEX we have a qualified personnel to carry out welding work that together defines an excellent job.

We have the following equipment:

Microwire welding  
Spot welding



# SERVICES



## ELECTROSTATIC PAINT

In order to control each production aspect of your project, we put our electrostatic paint booth at your disposal; it is a small line that has the necessary resources to carry out the painting as well as its adequate drying in the oven to achieve the desired detail. We have the optimal and experienced staff to advise you within this service, not without mentioning that we can apply a wide variety of colors and finishes to your piece.

## PROTOTYPING AND DEVELOPMENT

Print volume (WXDXH):

Single extruder: 330 x 240 x 240 (mm)

Double extruder: 295 x 240 x 240 (mm)

The material to use:

PLA/ABS /HIPS /PC /TPU /TPE /NYLON /PETG /ASA /PP /PVA /  
Glass Fiber Infused /Carbon Fiber Infused /Metal Fill /Wood Fill.

## ROD / SAW CUTTING

We have the necessary experience and resources to be able to carry out work under the highest standards of quality and demand. Taking our first steps within the metalworking industry in this area, we can guarantee that the desired service will meet all requirements.

Maximum cutting range (mm):      Cut dimensions in bundles:

D 320  
W 320 X H320

Maximum (mm): W290 X H140  
Minimum (mm): W220 X H90

## STAMPING

The Stamping division is an area equipped to meet the needs of our customers in stamping processes in the modalities of progressive, semi-progressive and manual through our equipment with operating capacities from 125 to 1600 tons capable of processing HSLA, dual phase, among others.

Our warehouses are all equipped with traveling cranes for the handling of coils and dies with capacities of up to 36 tons, thus being able to easily handle coils of 20 Tons, which is what our feed lines in presses are capable of handling.





# STAMPING



Talking about dies of different types also implies talking about the maintenance of them, for which we have our own tool workshop, and a group of experienced die makers that allow us to perform 100% of the maintenance at home.

We are an IATF 16949 Certified company prepared and equipped to meet the requirements of the Automotive industry and to be able to meet the expectations of the HVAC, White Line, Industrial, Residential industry.

Our equipment has a quick die change system, and our high-speed presses (125 to 300Ton) (60 to 120 GPM) capable of handling high-volume projects.

#	TONNAGE	Type	Bed	FEEDER
1	1000	PROGRESIVA	144 X 84 In	COE-60 In
2	1000	PROGRESIVA	144 X 84 In	CHS-72 In
3	1000	PROGRESIVA	144 X 84 In	COE-48 In
4	1000	PROGRESIVA	180 X 87 In	CHS-60 In
5	1000	MANUAL	120 x 48 In	Tandem Ilne
6	1000	MANUAL	120 x 48 In	Tandem Ilne
7	1000	MANUAL	120 x 48 In	Tandem Ilne
8	1000	MANUAL	120 x 48 In	Tandem Ilne
9	600	MANUAL	120 x 72 In	Tandem Ilne
10	400	PROGRESIVA	144 X 96 In	DALLAS-60 In
11	300	PROGRESIVA	98 X 98 In	Perfecto-30 In
12	200	PROGRESIVA	96 X 36 In	Vamco-24 In
13	150	PROGRESIVA	60 X 36 In	Vamco-12 In
14	1600	PROGRESIVA	144 X 96 In	CHS-72 In
15	125	PROGRESIVA	60 X 36 In	Vamco-12 In



#### SERVICES

##### Sheet Metal & Stamping

- Laser Machine
- CNC Turret Punching
- Roll Forming
- Bending
- Roll / Tube Laser Cut
- Bending
- Powder Coating Plant

##### Thermoplastic

- Design and manufacture own models
- CNC Router machines
- Thermoplastic machines

##### Machining

- Milling Centers
- Turning Centers
- Conventional Machines
- Welding

# CUSTOMERS



DEMATIC



## TECHNOLOGY IN THERMOFORMING

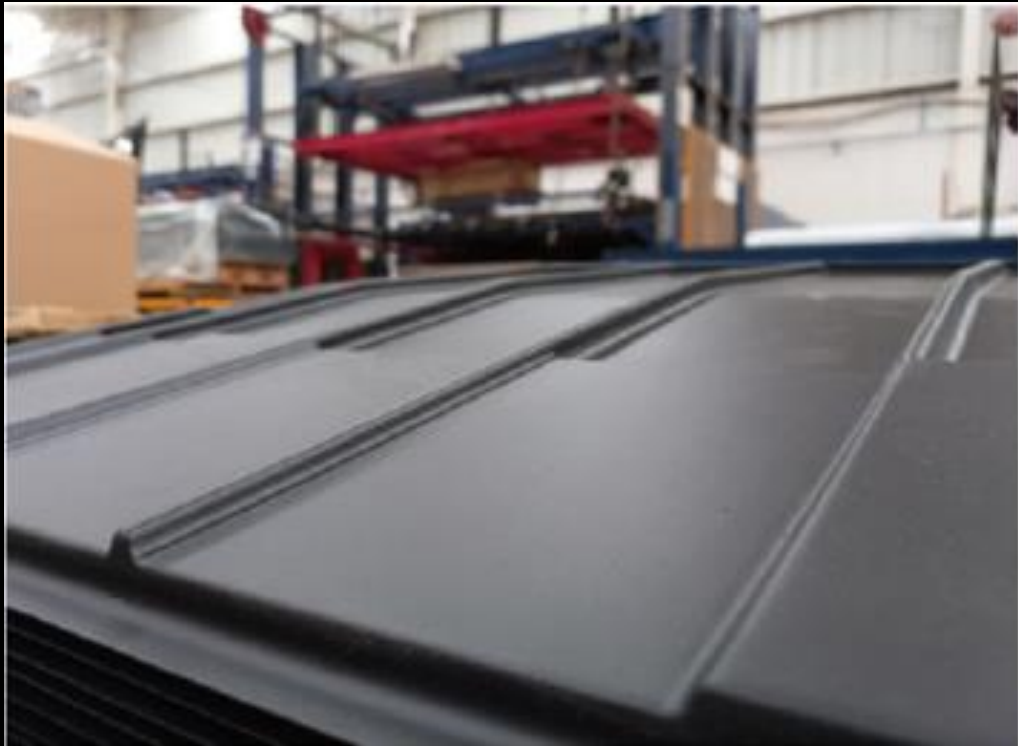

We are a company specialized in the thermoforming industry. We have solutions to your needs, giving our vast experience in the field. Our products are of the best quality, and we have the best and most qualified supplies of plastics in the country. Thanks to our capacity, experience and infrastructure, we have the firm commitment to become the most preferred Company in the field of plastics.

# SERVICES



## THERMOFORMING

We manufacture advertising and industrial pieces for external and internal identity. In addition of developing parts for the packaging industry.



## DEVELOP AND MANUFACTURE OF MODELS

We design high precision models for the thermoforming industry, from prototypes to high production models, using the best materials according to the needs and specifications of our costumers.

## CNC ROUTER

In order to satisfy the needs of our clients in needs of quality ,we set at your disposal 3 CNC Routers that gives an exact cut for those pieces in which quality is the preference.



## TECHNICAL ADVICE

We have a specialized technical department for the development of projects, modifications, advice on polymers and detection of needs.



# INFRAESTRUCTURE

## THERMOFORMER

CAPACITY OF:

**MACHINE 1** 1.00 MTS X 1.20 MTS

**MACHINE 2** 1.90 MTS X 1.45 MTS

**MACHINE 3** 1.90 MTS X 1.50 MTS

**MACHINE 4** 2.00 MTS X 1.50 MTS

**MACHINE 5** 3.00 MTS X 2.00 MTS

**MACHINE 6** 3.70 MTS X 2.00 MTS

## ROUTER CNC

CAPACITY OF:

**MACHINE 1** 1.00 MTS X 1.20 MTS

**MACHINE 2** 1.90 MTS X 1.45 MTS

**MACHINE 3** 1.90 MTS X 1.50 MTS



## IDEAS

Tell us about your idea, we can help you to create new solutions.

## PROTOTYPE

We have an extensive variety of materials, color and textures.



## FINISHED PRODUCT

Your idea come true, just like you need it.







# CUSTOMERS



# HUSSMANN®



# MACHINING

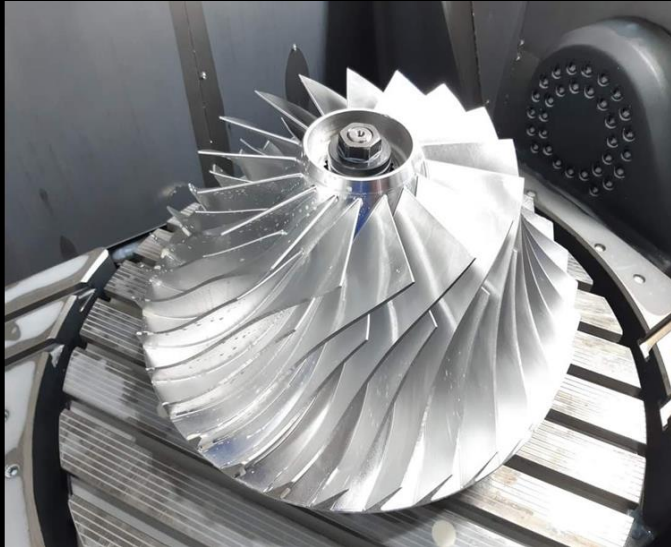

We are a Tier 2 company, dedicated to the manufacture of components for the industry at a global level, with more than 20 years of in the market, in order to provide a service with the highest standards of quality, always being committed to provide our work with the necessary haste and with the best quality in materials and labor, using specialized personnel, equipment and the appropriate tool for its manufacture. Since our processes range from design, machining, roll cutting, laser cutting, water cutting, welding assembly, mechanical assembly, spray paint coatings, powder painting or e-coat painting. We serve industries such as: automotive, energy, white goods, electronics, food, oil.

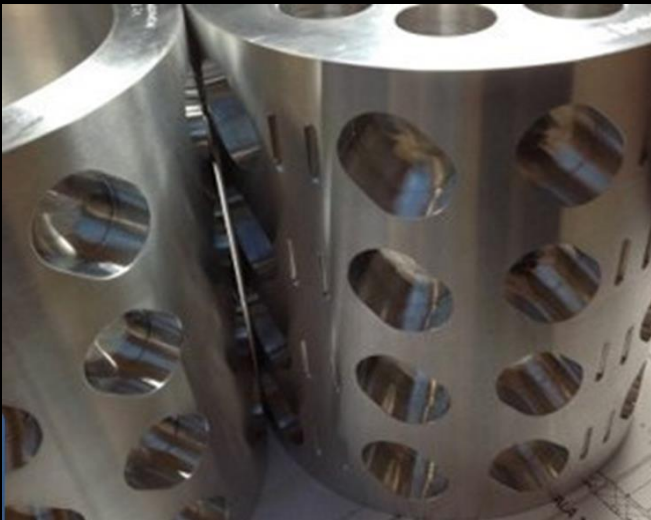

## HAAS TL-3, ST 30, ST15





# MACHINING CENTERS

HASS VF2, VF4, VF9, TM2P, VF5.  
ROMI D600, 4to EJE.

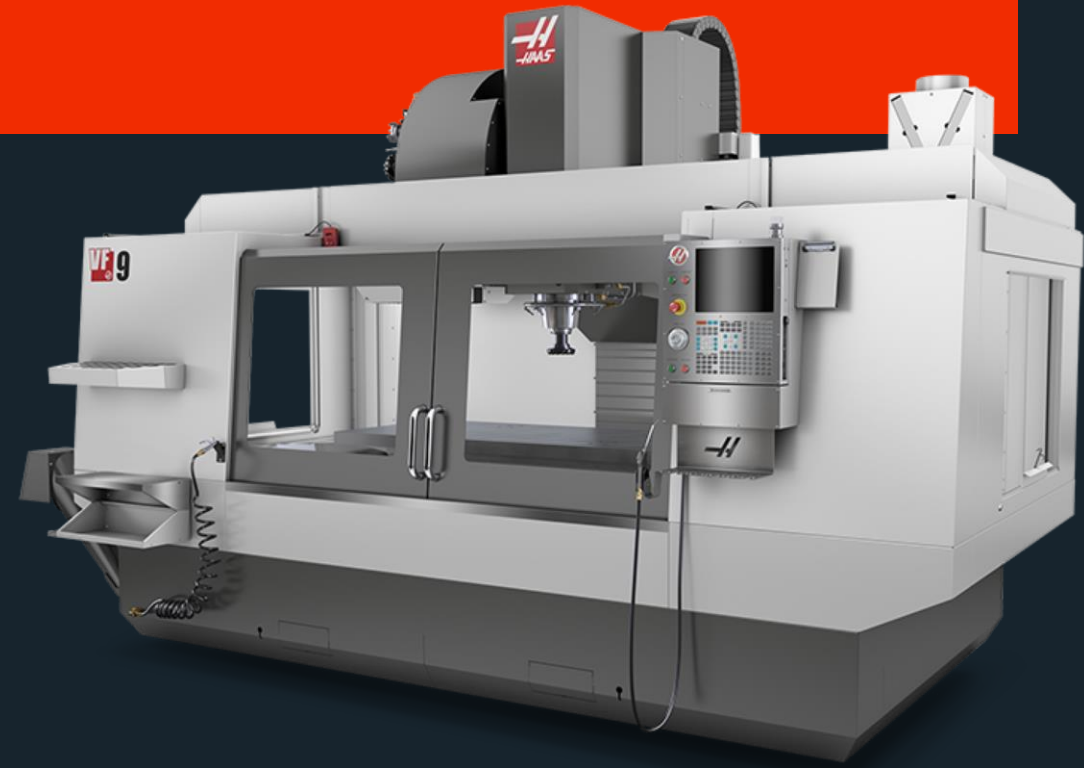

# MANUFACTURING

- Mounting device
- Blades
- Arrows
- Gear
- Grinding of flat and cylindrical surfaces
- Blades
- Titanium Coatings
- Sealing jaws
- Mold Manufacturing
- Bushings
- Manufacture of guards
- Reengineering for machinery.
- Carriers
- Manufacture of Conveyors
- Metal Structures
- Automotive industry assembly.

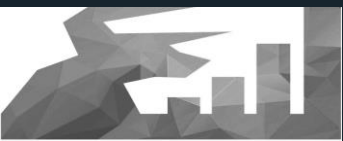
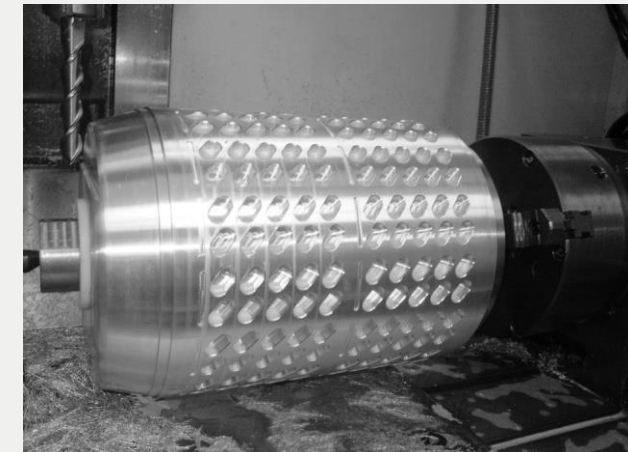
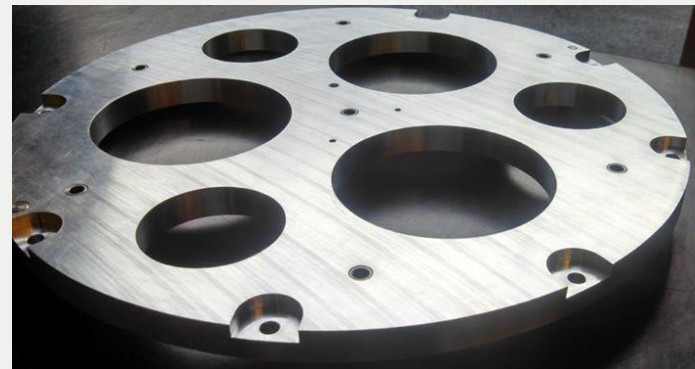
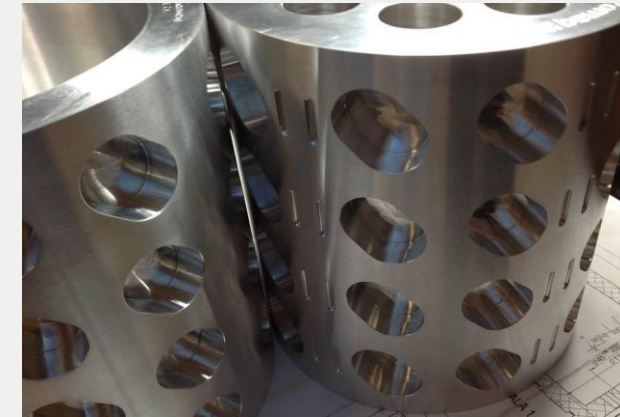
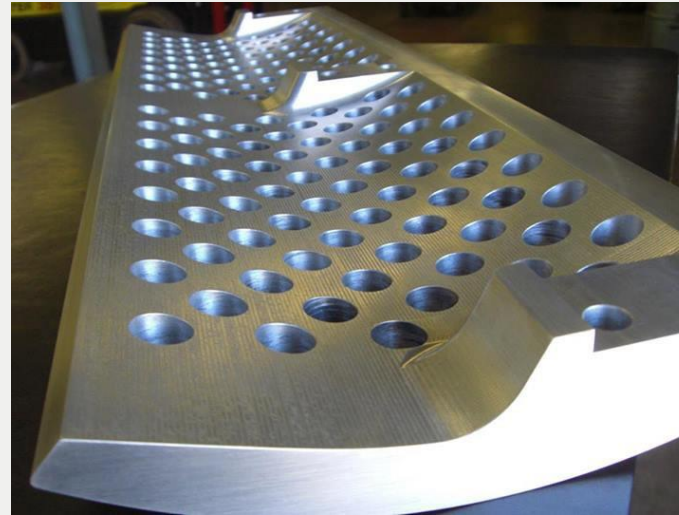



# WELDING PROCESSES

Elaboration and Certification of welding procedures according to the most recognized international codes ASME, AWS, API, etc.

Welding inspection by personnel certified as CWI. Qualification and certification of welder skill through non-destructive testing by welding inspectors recognized by AWS, EWF and iiW.

Technical advice for the solution of problems in welding processes. Training in the main welding codes: ASME Sect. IX (with recognition by ASME International), API; AW



# Our Customers

Providing our services with the same quality standards to Micro and Medium Enterprises, to which excellent service is provided.

Participating in this way in the continuous growth and increasing the competitiveness of Mexico's industrial industry.

CLIENTES:

