



**PLASTIC INJECTION / MANUFACTURING SOLUTIONS**  
**[www.isgo.com.mx](http://www.isgo.com.mx)**

**ISGO MANUFACTURING** is a 50+ year old IATF/TS16949 –certified, Tier 1 / Tier 2 custom injection molding and assembly company.

We have manufacturing facilities in Monterrey, San Luis Potosi and Puebla, Mexico; a Tool Shop in San Luis Potosi, an Engineering Tech Center in Detroit, Michigan and Program Management Support in Germany.

Our machine sizes range from 50 to 2,000 tons.

**ISGO** currently manufactures and assembles plastic components for 2 market segments:

- **Precision**

- **Class “A”**

*We are implementing scientific molding methodology in our precision components through molding process specialists with over 20 years of experience.*



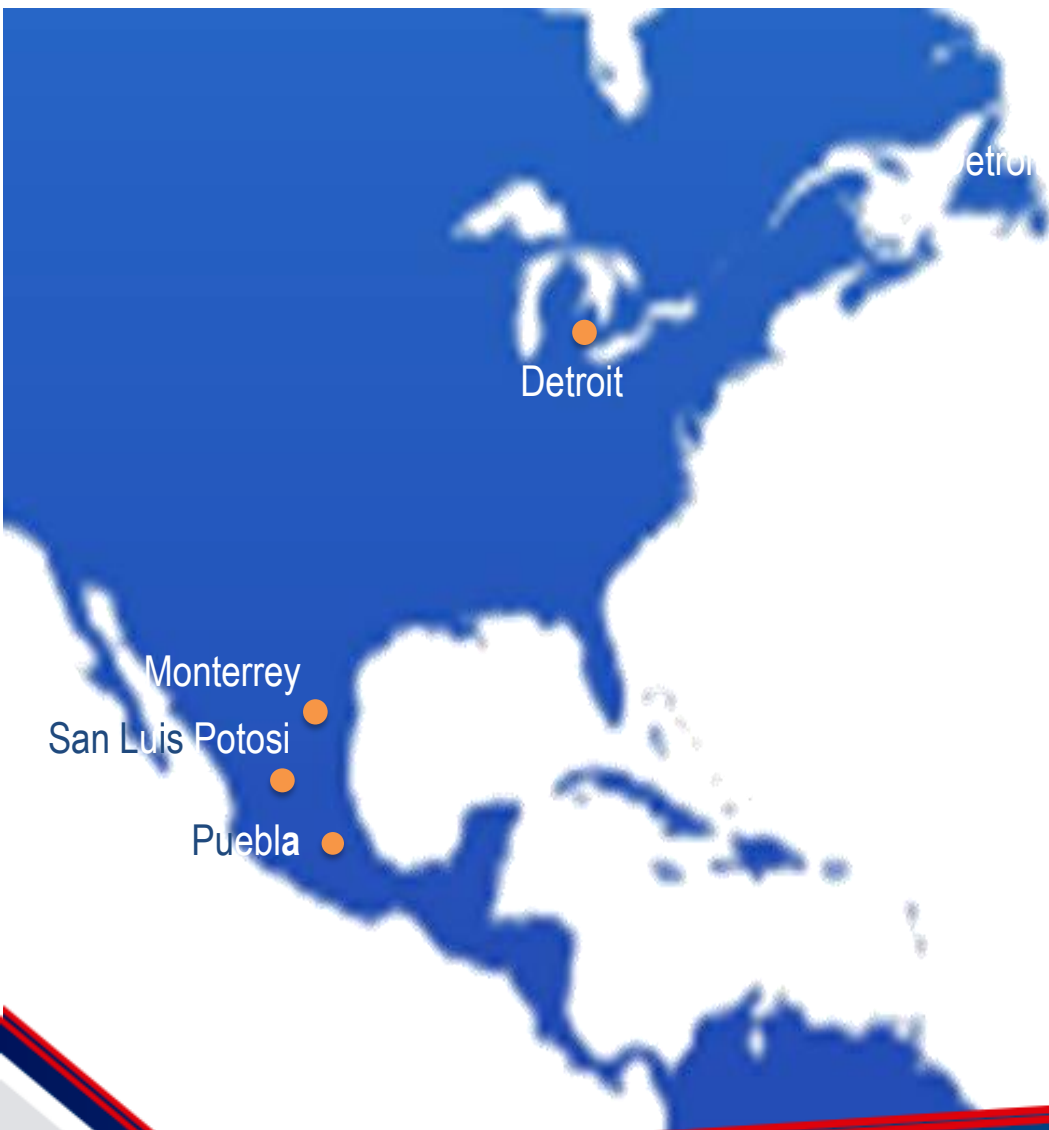

➤ **ISGO NA**  
Sales Service,  
Program Management  
& Engineering

➤ **ISGO MEXICO**  
Manufacturing  
Tooling

➤ **ISGO EUROPE**  
Sales Service &  
Program  
Management



## COMBINED GROUP SALES

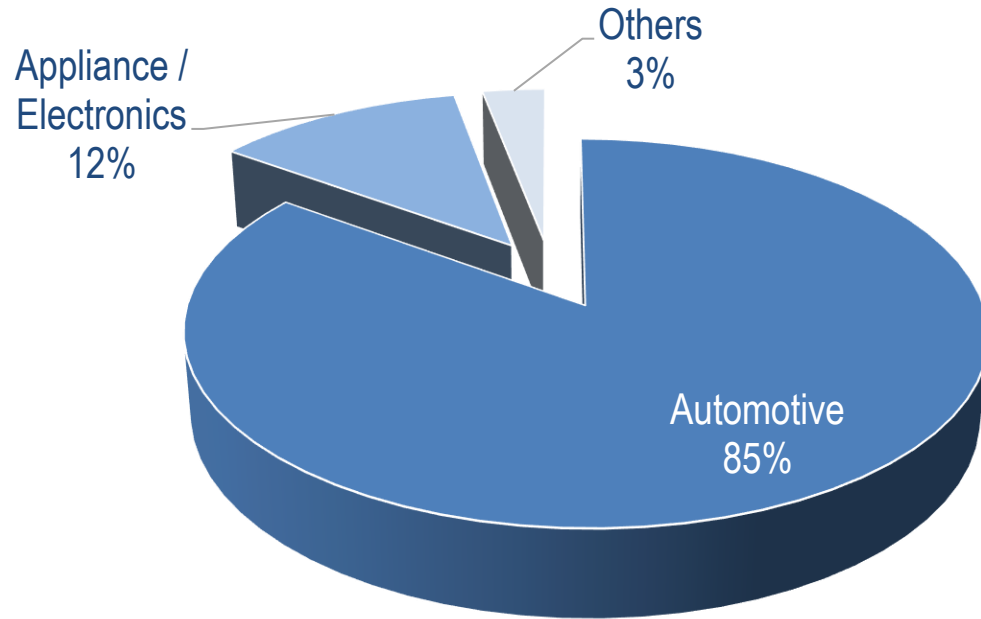

➤ 2021 \$85M USD

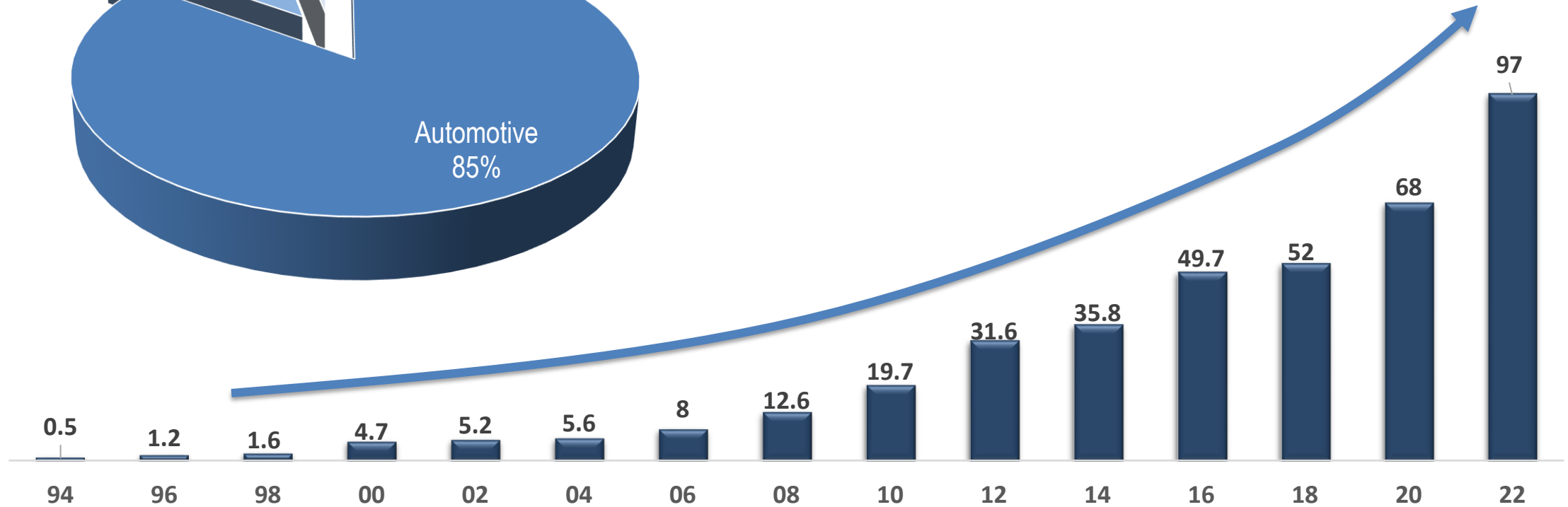

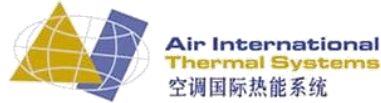



## LEADING OEMs

through our Tier 1 and Tier 2 Customers



LUCID

## UNDERHOOD

- Fluid Management
- Radiator Components
- Transmission
- Electrical
- Pedal Assembly
- Reservoirs
- Engine Covers

## EXTERIORS

- Moonroof Subassembly
- Front / Rear Fascia Inserts + Structure
- Rear Spoiler
- Lighting
- EV Charging Station

## INTERIORS

- IP, Door, Console, Trunk Class A, Substrates, Structural
- HVAC Housings
- Pillar Covers
- Seating Structural + Trim
- Speakers

## VEHICLE CONTENT PARTICIPATION

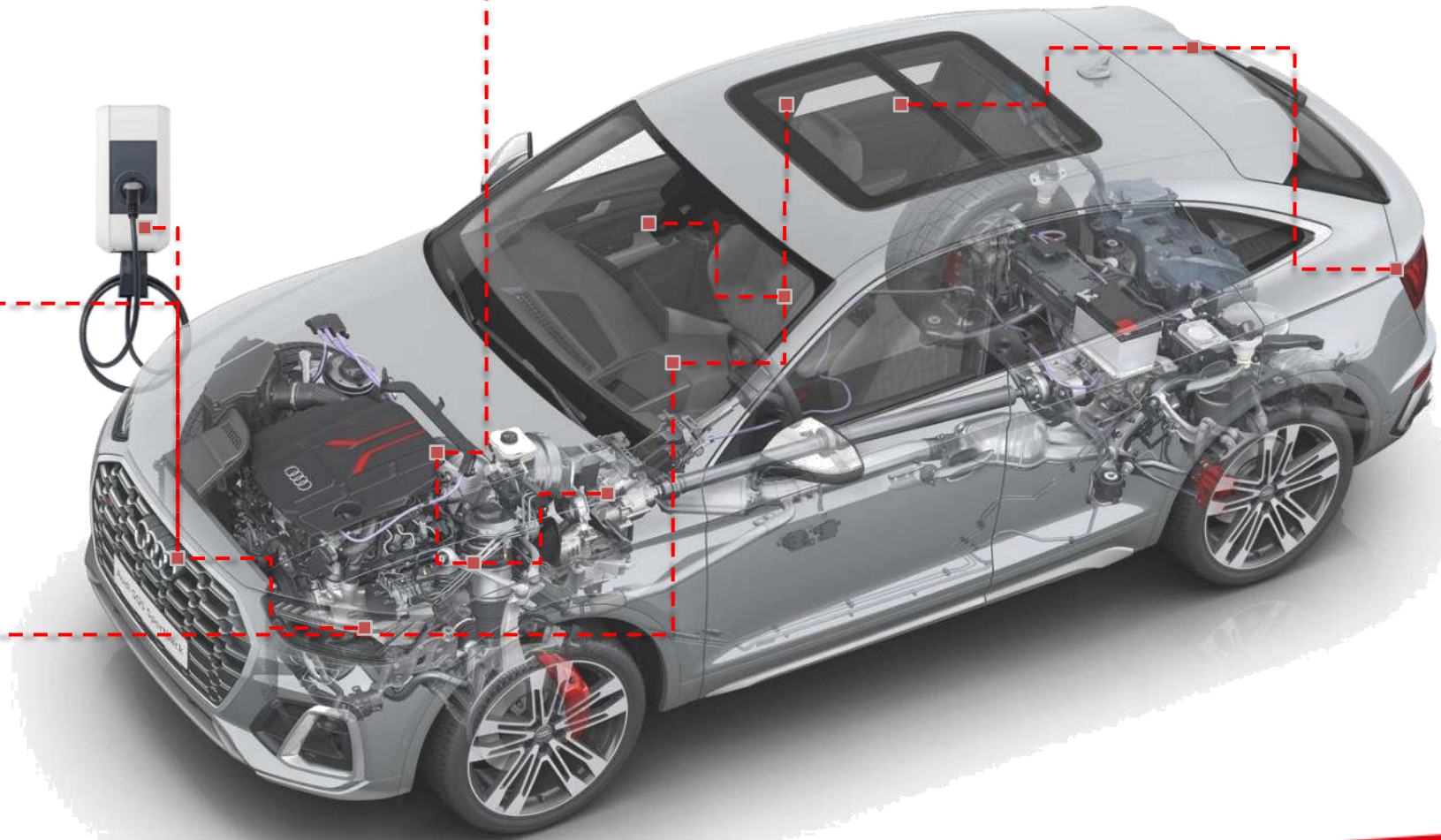





- 117,000 sqft / 13,000 m2
- 2 Buildings
- 45 machines 50 - 2000 T
- Blowmolding
- Started Operations in 1967

## MONTERREY LAYOUT



## RECENT INVESTMENTS

- 9 IM Machines (all new)
- 2K Double Shot Molding Cells.
- Increased Press Size to 2000T

GREENFIELD  
AVAILABLE FOR EXPANSION  
5000 m2





## SAN LUIS POTOSI



- 100,000 sqft / 9,100 m2
- 58 machines, 50 -1000 T
- Started Operations in 2008



## SAN LUIS POTOSI LAYOUT

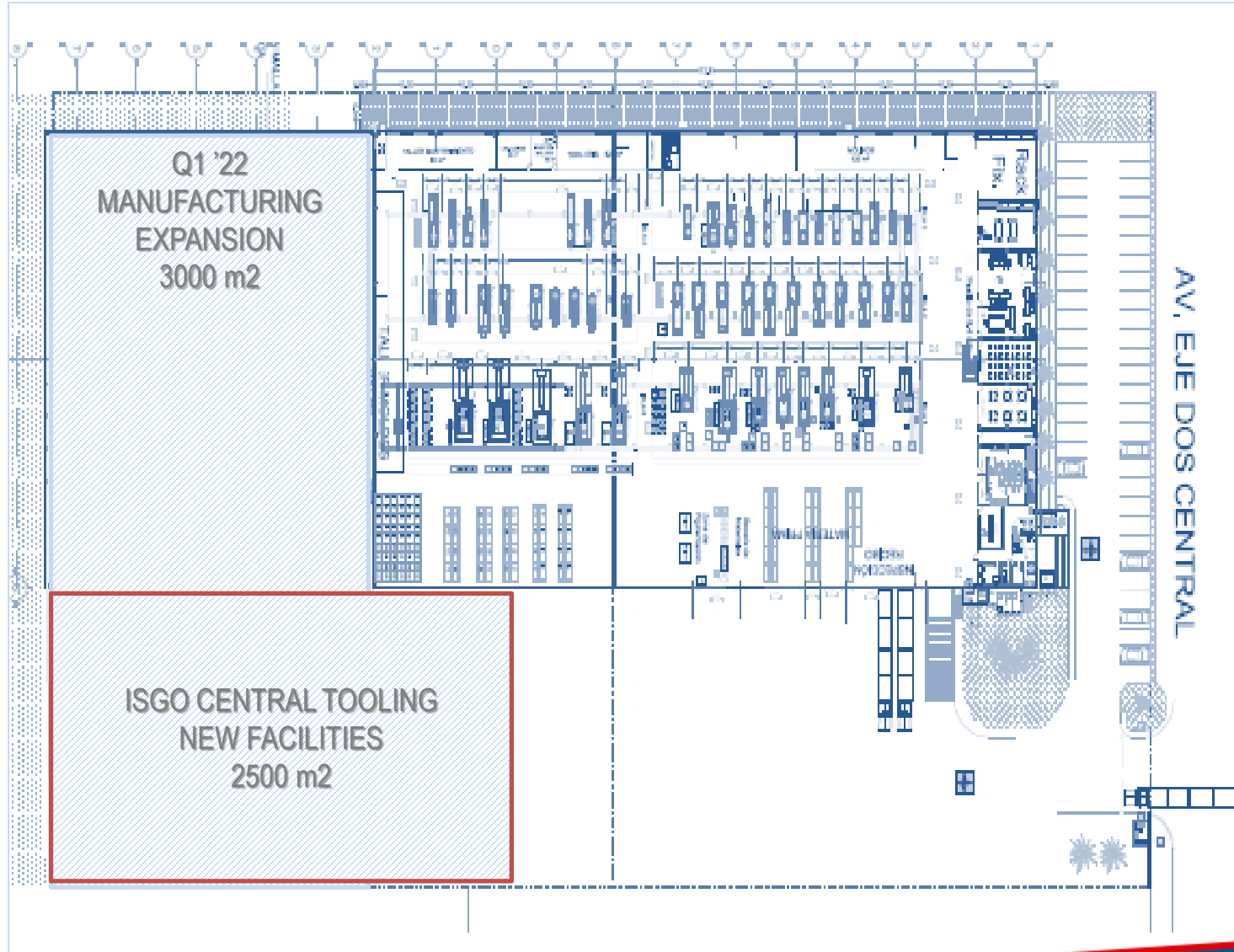

### RECENT DEVELOPMENTS:

- Added 6 IM Presses, up to 900T.
- Added 2K IM.
- Broke ground on Building Expansion (Completion in Q1 2022).
- Passed Operations, Logistics and Sustainability Audits for VW / Audi



## PUEBLA



- 45,000 sqft / 5,000 m2
- 8 machines, 140 -1100 T
- Started Operations in 2019



## PUEBLA LAYOUT

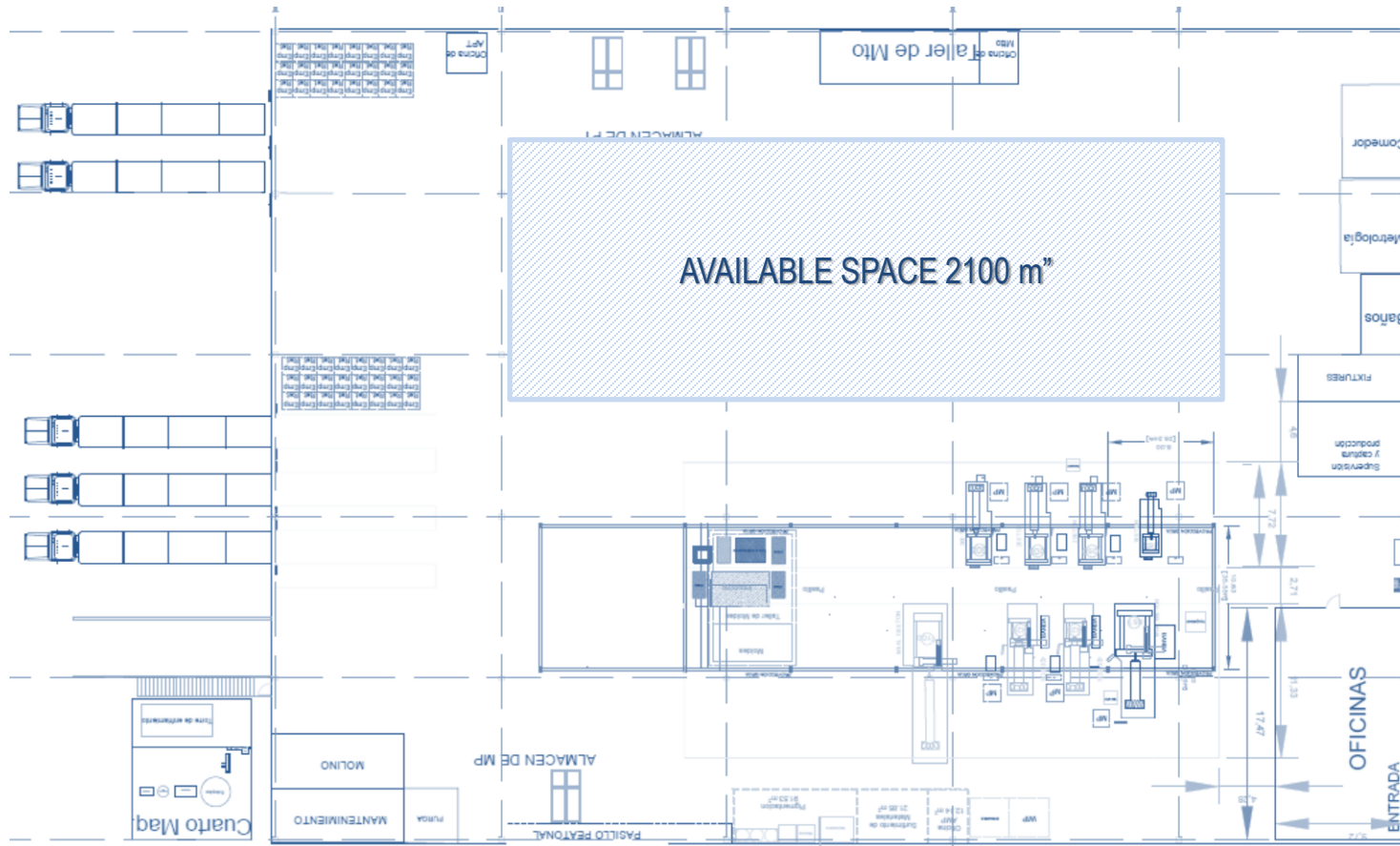

### ONGOING DEVELOPMENTS

- 2x New IM Automated Cells
- Increased Capacity to 1100T.
- Fully Equipped Lab (CMM)
- Working directly with VW Group.

## METROLOGY

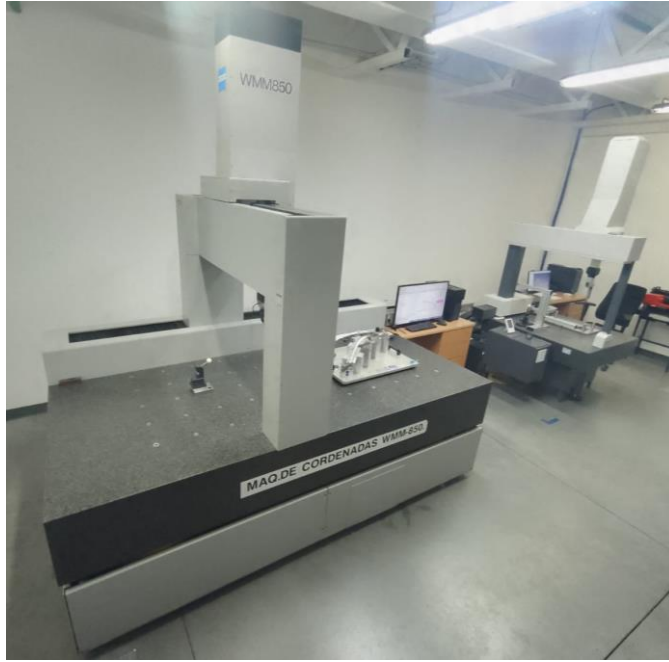

In-house competences to validate and control all S/C characteristics for all products we supply.

- CMM at each site
- Faro Arm
- Pull / Compression Testers
- Resin Humidity Control
- Temperature Measurement
- Gage Validation
- Optical Measurement
- Color Measurement
- SPC/CpK/PpK Validation & Sampling.



- 24 / 7 Support for tools for our plants & external Customers
- Preventive, Corrective Maintenance, Engineering Changes
- Complete Tool Fabrication
- Partners in China, North America and Europe



## CURRENT ON-SITE CAPABILITIES



- Siemens SolidEdge CAD / CAM
- Faro Arm
- 5x CNC Machining Centers, 3 axis.
- 4x Wire, Sinker and Drill EDM stations units.
- Precision Lathe up to 305 x 1520 mm
- 3x Knee Mills
- 3x Cutter Grinders
- Band Saw with Laser Guide
- MIG / TIG + Laser Welder stations.
- Heat Treatment Oven.

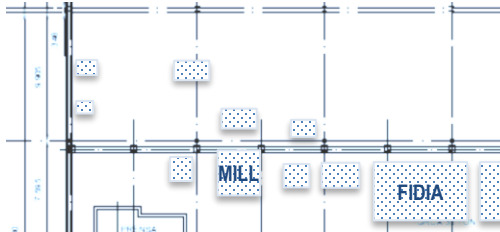

- **Dedicated Built-to-Suit Facilities next to our SLP Plant.**
  - **Increases our ability to work with tools up to 3200 T press-size.**
  - **Under Construction, to be completed Q1'22.**
  - **Increases capacity for up to 3200-Ton Press-Size molds**
- 
- **3x additional CNC Centers, in 5 axis**
  - **Radial Drilling to 3" diameter**
  - **2x Boring Mills,**
  - **350 T Spotting Press**
  - **35 T Overhead Crane**
- 
- The diagram is a schematic floor plan of a manufacturing facility. It shows a large rectangular area divided into sections by dashed lines. On the left side, there are two vertical dimensions: '15,000' and '17,000'. In the center, there is a large rectangular area labeled 'MILL'. To the right of the 'MILL' area, there is another large rectangular area labeled 'FIDIA'. The plan also shows various smaller rectangular areas, some with dotted patterns, and a network of lines representing structural elements or material flow paths.

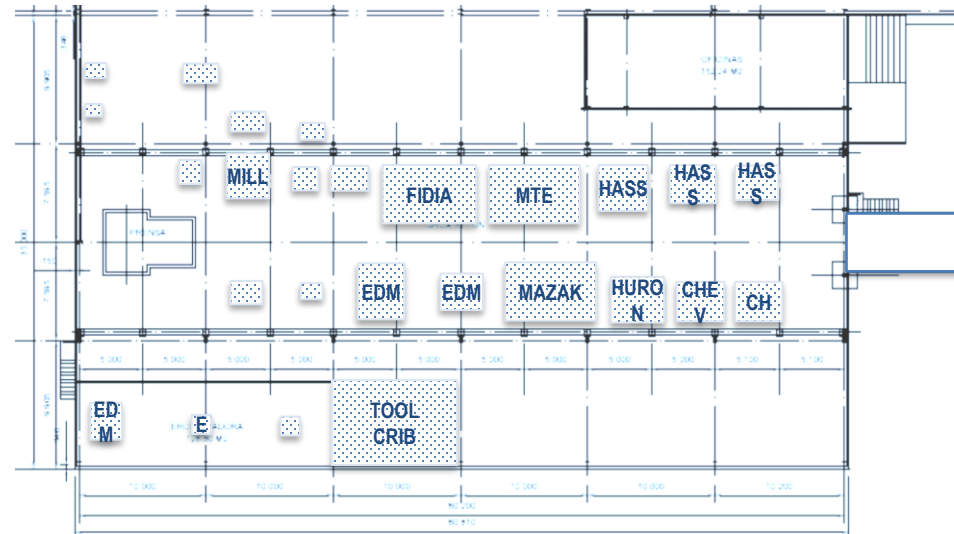



*We believe that there is a huge gap  
between the auto precision plastic needs &  
the current North American supply.*

*ISGO is here to fill that gap.*