

**GLM**  
**Components México**  
**SA de CV.**

**Priv. San Cristobal #111-A**  
**Chachapa Amozoc,**  
**Puebla.**

**GLM**

**[www.glmgroup.com](http://www.glmgroup.com)**

***Your Partner for***  
***Automotive***



# COMPONENTS MEXICO

DIVISION

## History of GLM

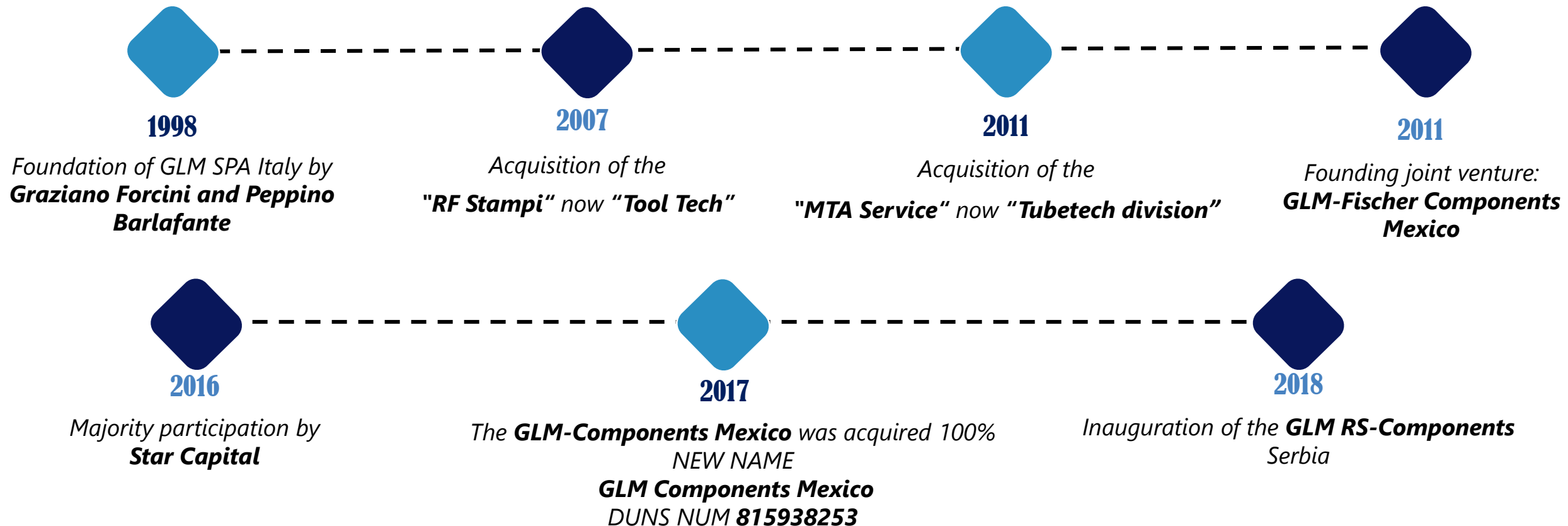



# COMPONENTS MEXICO

DIVISION

*GLM Industry*

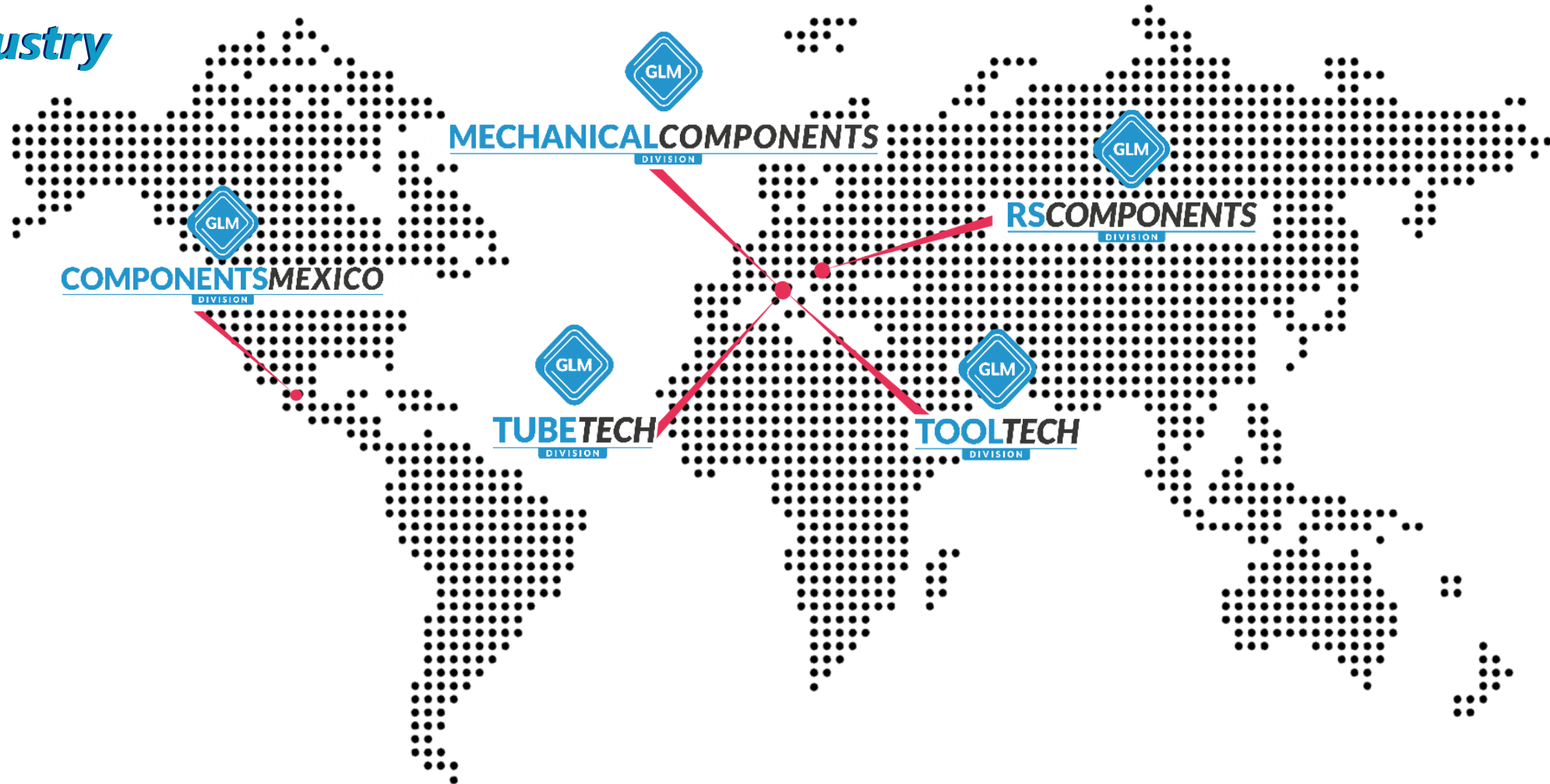



## COMPONENTS **MEXICO**

DIVISION

### *Turnover by plant*

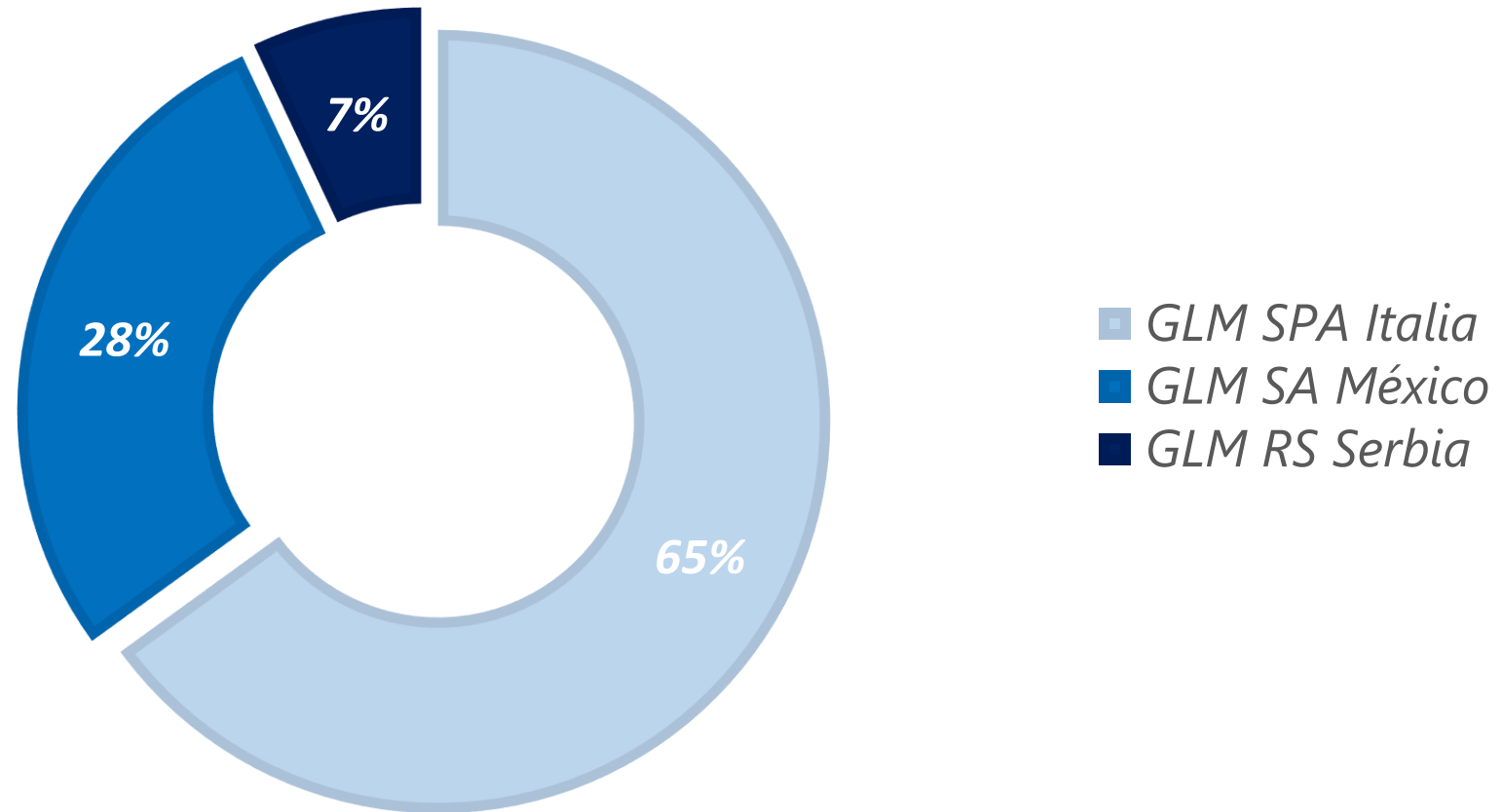



# COMPONENTS MEXICO

DIVISION



**130**  
*Employees*

**4500 SQ.M.**  
*Area*

**Chachapa, Mex.**  
*New Plant*



## COMPONENTS **MEXICO**

DIVISION

### *Our customers*





# COMPONENTS MEXICO

DIVISION

## Sales Split 2021

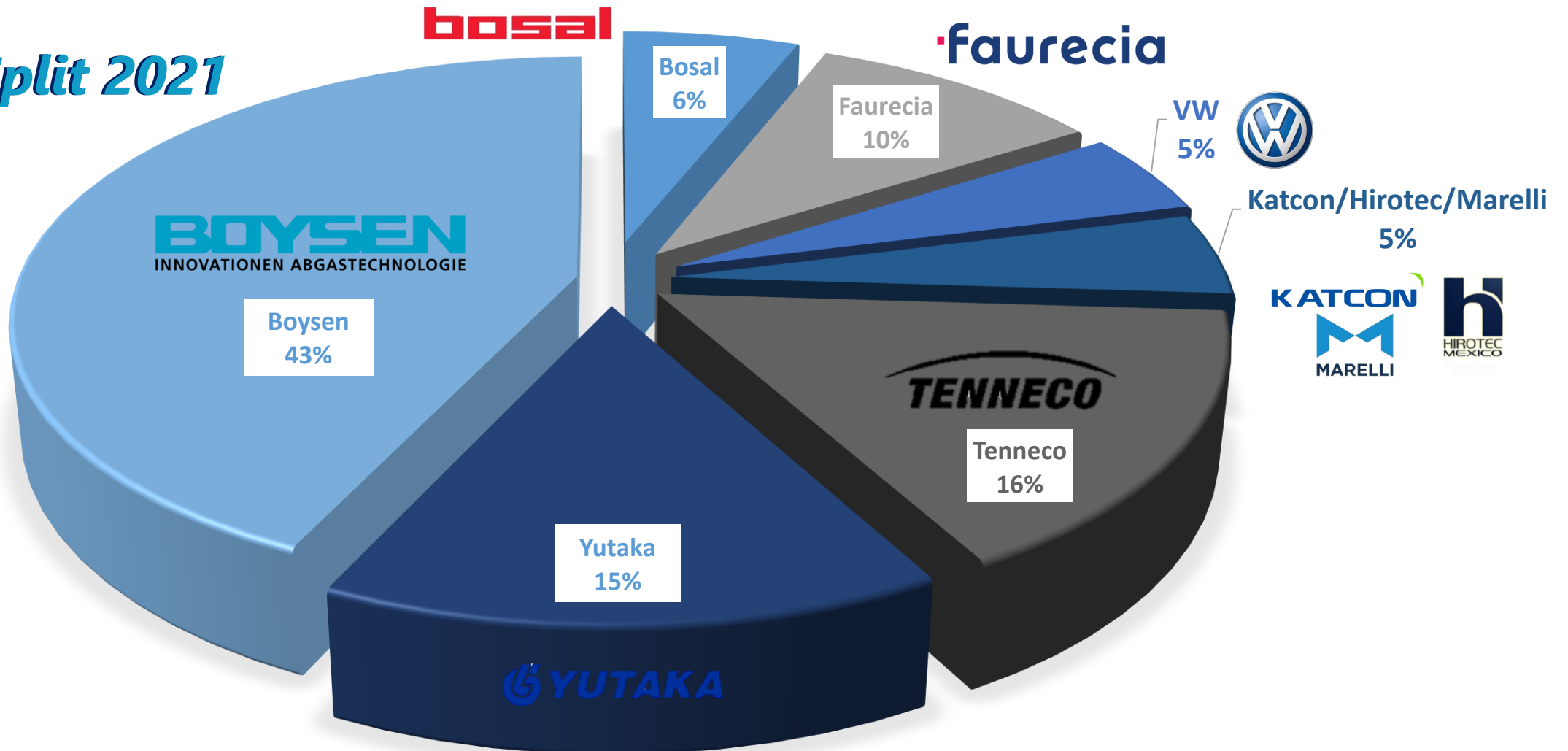



## COMPONENTS MEXICO

DIVISION

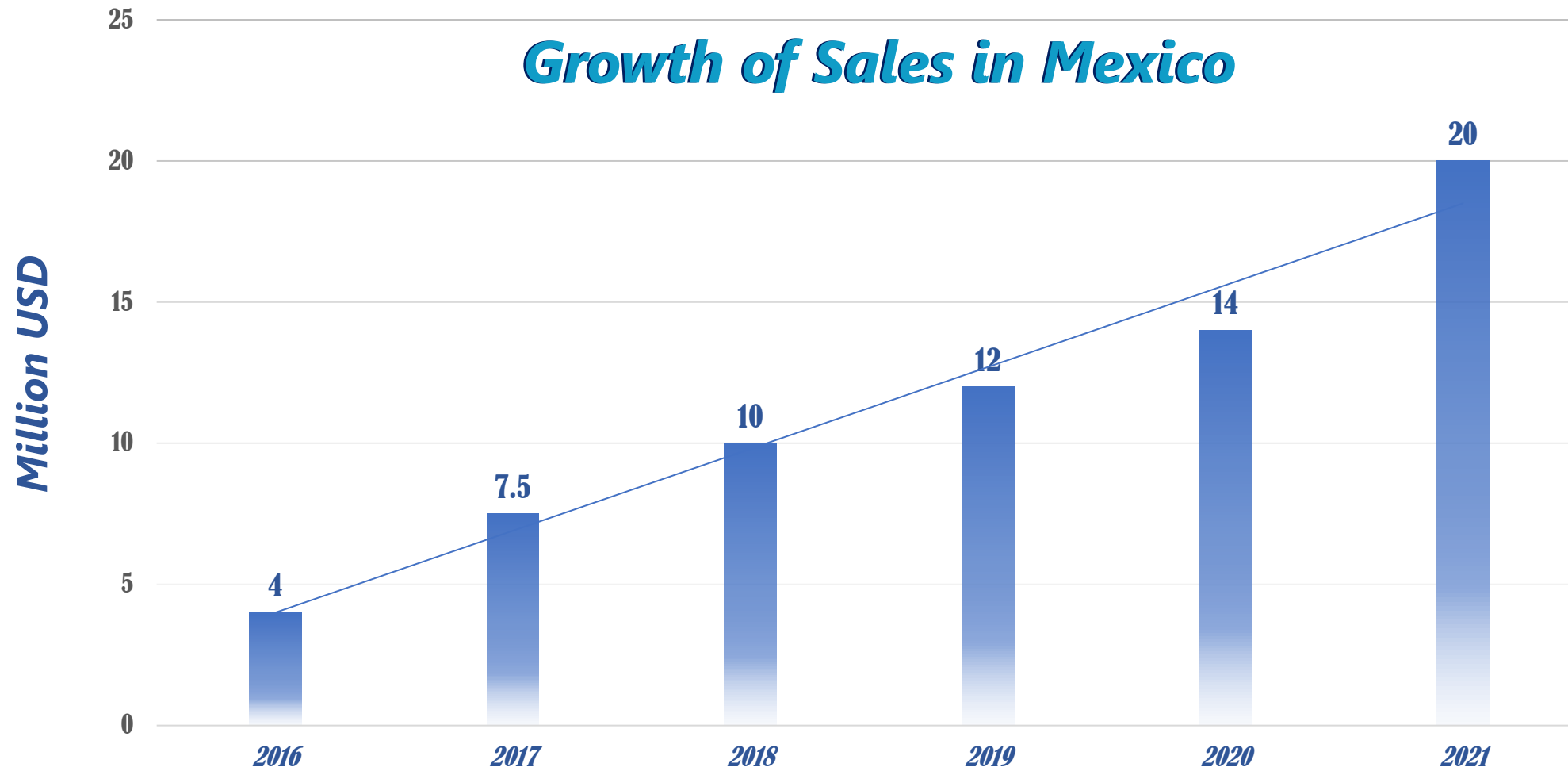



# COMPONENTS **MEXICO**

DIVISION

## *World Wide Competitive*



**58%**

***Exported Products***  
*(Alabama, Tennessee, North  
Carolina and South  
Carolina)*



# COMPONENTSMEXICO

DIVISION

**TUBES**

**STAMPING**

**SEATS  
COMPONENTS**

**QUALITY  
EQUIPMENT**

**PRESSURE  
PIPES**

**ASSEMBLED  
PRODUCT**

**PRESSING  
MACHINES**

**QUOTES**  
**Appendix**

**RODS**

**SPECIAL  
ASSEMBLIES**

**MACHINES**  
**MACHINES pt. II**

**CERTIFICATIONS**



# COMPONENTS **MEXICO**

DIVISION



## ***TUBES***

*Exhaust Hanger Tube. Wide range of products from ø 6mm to ø 16mm*





# COMPONENTS MEXICO

DIVISION



## **PRESSURE PIPES**

*Water Pipes and for cooling system.  
Wide range of bending from  $\varnothing$  6mm  
to  $\varnothing$  16mm*





# COMPONENTS MEXICO

DIVISION



## RODS

*Exhaust Hangers Rod Solid. Wide range of products from ø 6mm to ø 16mm*





# COMPONENTSMEXICO

DIVISION



## STAMPING

*Brackets, Holders, nut boxes, washers,  
Thickness since 0.6 mm- 4.0mm, Stainless  
Steel, Carbon Steel*





# COMPONENTS MEXICO

DIVISION



## ASSEMBLED PRODUCTS

*Bracket Assembly  
Robotic Welding*





# COMPONENTS MEXICO

DIVISION



## **SPECIAL ASSEMBLIES**

*Different Assemblies can be made with stampings of parts from our facilities, some examples such as Spot welding, rubber assembly*





# COMPONENTSMEXICO

DIVISION

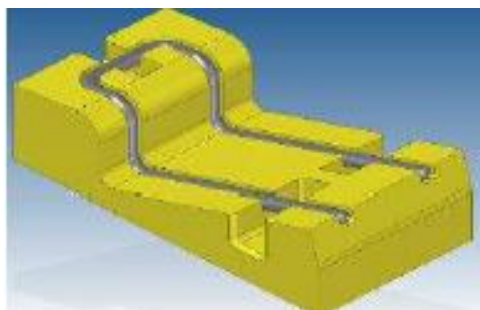

## SEATS COMPONENTS



Examples of:

- Fiat head support
- Control Gage
- Process





## MACHINES

### **Bending Machine:**

*Machines with cut, forming a bending  
Tube / Rod*

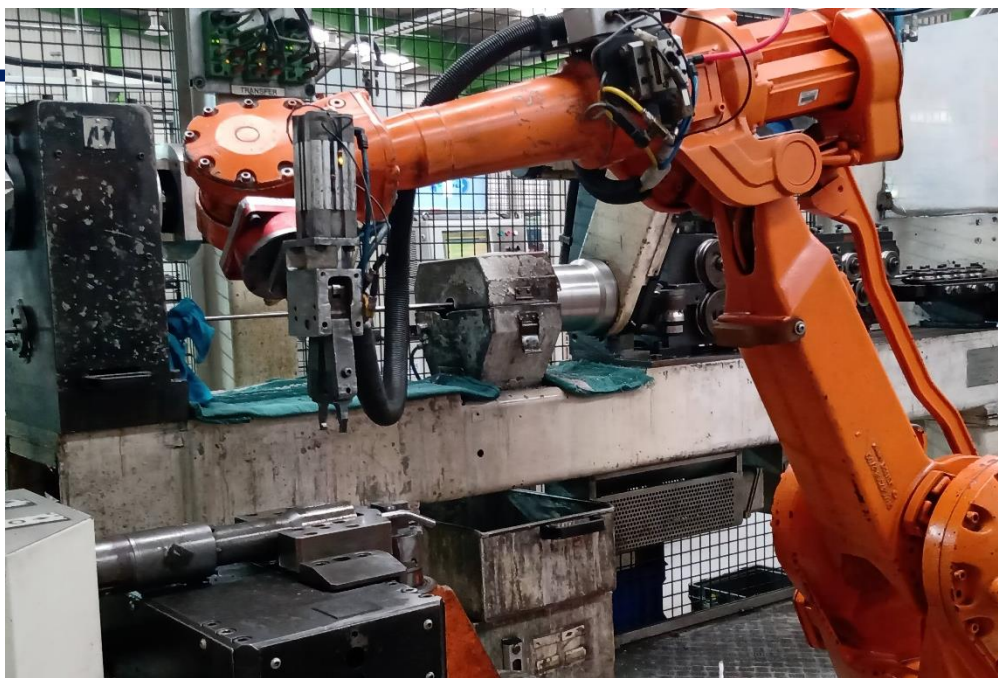

### **Crippa Machine:**

*This machine Works with length tube, can  
make special forming and use different  
tools*



## **MACHINES** *pt.II*

### ***Welding Cells:***

*This machine is feeding by an operator and the welding process is automatically*





**COMPONENTS**MEXICO  
DIVISION



***PRESSING MACHINES, SINCE 2018***



**Press 1:150 Ton**



**Press 2:300 Ton**



**Press 3:200 Ton**



# COMPONENTSMEXICO

DIVISION



## QUALITY EQUIPMENT

**Metallographic tests**

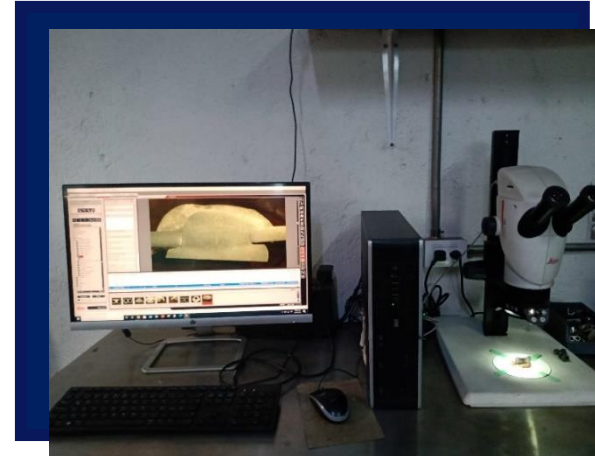
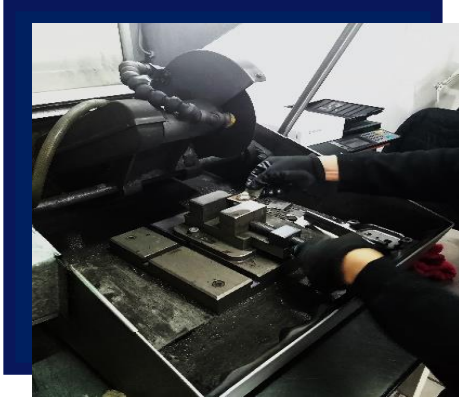

**Hardness tests**



**Profile Projector**



**CMM**





# COMPONENTSMEXICO

DIVISION



THE INTERNATIONAL CERTIFICATION NETWORK

## CERTIFICATE

DQS has issued an IQNet recognized certificate that the organization

**GLM Components México, S.A. de C.V.**

Antiguo Carril San Cristobal Km. 14.5, Autopista Puebla Orizaba  
Parque Industrial Chachapa, Amozoc  
C.P. 72990, Puebla  
México

has implemented and maintains a **Quality Management System**.

for the following scope:  
Manufacture of steel products.

which fulfills the requirements of the following standard:

**ISO 9001 : 2015**

Issued on: 2021-01-06  
Expires on: 2024-01-01

This attestation is directly linked to the IQNet Partner's original certificate and shall not be used as a stand-alone document.

Registration number: DE-10014835 QM15



*Alex Stoichitov*  
Alex Stoichitov  
President of IQNet



**IQNet Partners:**

AENOR Spain AFNOR Certification France APCER Portugal CCC Cyprus CISO Italy  
CQC China CQM China CQS Czech Republic Cro Cert Croatia DQS Holding GmbH Germany EAGLE Certification Group USA  
FAV Brazil FONDONORMA Venezuela ICONTEC Colombia Inspira Seritoint Oy Finland INTECO Costa Rica  
IRAM Argentina JQA Japan KFO Korea MIRTEC Greece MSZT Hungary Nemko AS Norway NSAI Ireland  
MYCE-SIGE México PCB Poland Quality Austria Austria RR Russia SII Israel SIQ Slovenia  
SIRM QAS International Malaysia SGS Switzerland SRAC Romania TEST St Petersburg Russia TSE Turkey YUQS Serbia

\* The list of IQNet partners is valid at the time of issue of this certificate. Updated information is available under [www.iqnet-certification.com](http://www.iqnet-certification.com)



## CERTIFICATE



This is to certify that

**GLM Components México, S.A. de C.V.**

Antiguo Carril San Cristobal Km. 14.5, Autopista Puebla Orizaba  
Parque Industrial Chachapa, Amozoc  
C.P. 72990, Puebla  
México

has implemented and maintains a **Quality Management System**.

Scope:  
Manufacture of steel products.

An audit, conducted and documented in a report, has verified that this quality management system fulfills the requirements of the following International Automotive Standard:

**IATF 16949:2016**  
(without product design)

Certificate registration no. 10014835 IATF16  
Issuing date 2021-01-06  
This certificate is valid until 2024-01-05  
IATF No. 0390031



2-IAQ-QMC-01001

For and on behalf of DQS

*Nurani S. Venkatachalam*

Nurani S. Venkatachalam  
Director-Corporate Automotive Program, DQS Holding GmbH

*Michael Drechsel*

Michael Drechsel  
Managing Director, DQS Holding GmbH

IATF Contract Office: DQS Holding GmbH, Konrad-Adenauer-Allee 8-10, 61118 Bad Vilbel, Germany

2021-01-06



**COMPONENTS**MEXICO  
DIVISION



# ***Yutaka Technologies, LLC Recognition***

## ***"Outstanding Quality Performance"***





# COMPONENTS MEXICO

DIVISION



## VW Audit Level "A"

### Process and Product Audit

Supplier:  
GLM COMPONENTS MEXICO SA DE CV

Supp. / KRIAS Nr:

Order-requestor:  
Quality Purchasing Parts

Order:  
VA 212416

Date:  
11/01/2018

Manufacturer code:  
YCZ

Location:  
PRIVADA DE CARRIL SAN CRISTOBAL N111-A  
72990 CHACHAPA (MEX)

D&B D-41-N-89/ FST-Nr.:  
81-593-8253

Order-reason:  
New production site

#### Process Audit

Nr.:	Product Group:	PG-M	Es [%]	Rating	A	B	C
1320	Tube-Profile Form	VW-K-S	90	A	0	0	0

VW-K-S = Supplier for the series production; GLF = Supplier for low delivery quantity; BHKW = Supplier for BHKW (coproduction units); VW-Z = Supplier for Volkswagen Zubehör GmbH; VW-E = Supplier for Economy Parts; VW-OET = Supplier for genuine parts; HWH = Handwerks; GP = Armoured Vehicles; ASH = Aufbaueinsteller; AB = Rework, preparation; T&B = Truck&Bus; T&B GLF = Truck&Bus for Gerings Liefermenge; VW-MS = MotorSport

For re-assessment of a C Rating result, the threshold is a B rating is  $E_p \geq 85\%$ . Downgradings according to Formel Q Capability are possible (reasons see below). When not meeting the Self Audit- and/or not achieving the required "A"-Rating threshold (grade of fulfillment  $\geq 80\%$ ) during the verification audit, we reserve the rights, to regress according to Formel-Q Capability.

Grading scale: A=90 - 100% Quality Capable; B=80 - 89% conditionally Quality Capable; C= 0 - 79% not Quality Capable.

#### Previous audit results/certificates

Audit Type	Date	conducted by	Result / Certificate No.
IATF 16949:2015	Nov 2017	DGS	Audi
Self Audit VDA 6.3	Dis 2017	GLM Components	Date/Werkst. Nr. A 93%
Formel Q VDA 6.3	April 2015	ACE VWMex	B 88%

Corrective Actions and 'Individual Results' in 'Immediate Actions'

Conducted by: Huerta Espinosa, Edgar (M-GDL1)

Audit Manager: Salvador Guevara B (M-GDL1)

Mr. Franco Albano  
Supplier Management

© Volkswagen Aktiengesellschaft / FQF 8.0 Juni 2015, Excel\_V\_1.2

2/9

#### Statements / Requirements

Statement: GLM Components Mex. is part of GLM Group, with headquarter in Castelnuovo Italy, the plant located in Puebla produce tubes-brackets for different applications and different customers: Bosal, Yutaka, Faurecia, Hirotec, Tenneco, etc.

The supplier is in process of expansion, integrating the stamping process with 3 new presses of 150, 200 and 300 tons.

Currently for VW only produce tube-brackets for the muffler system, used in different programs: VW 324, VW 325, VW 326, VW370, VW371, Etc., delivering parts as T1 and T2 through Tenneco supplier.

**Audit Reason:** The objective of this audit is to assess a the Q-Fähigkeit (after Transfer production from GLM Fisher to GLM Group).

The Product group evaluated are: 1320 (tube/Profile form) with next steps process: cutting, formed, and bending).

**Conclusion of VA Process Audit:** All equipment to produce the pieces is installed, most of the re-qualification of pieces with VW are in note\_1 and 2DP in green status, the equipment required to control the quality is working, the current conditions in the new facilities allows a better flow of the material. The performance in the last years with VW and other customer has been in target. However GLM Components must strengthen some areas to reduce the risk in all productive chain, and fulfill all customer requirements of VW Group.

#### Significant findings:

- \* Improve the control of quantities, locations, FIFO control of material in storages (new MRP system is process to be implemented).
- \* To get a note\_1 for the rest of parts for VW
- \* Reinforce the back up plan for key position e.g. metrology area, customer service, etc.
- \* Lack of access to all systems with VWGroup: e.g. SCC, Specific brand information, Quality LAH)
- \* Finish all Basic training for VWGroup. (PSB, cert in VDA 6.3)

#### Product Audits:

Tube/Profile form: Pieces in specification (dimensional and material)

The result of the self audit could not be confirmed.

1. Date Improvement Plan: ---



**COMPONENTS**MEXICO  
DIVISION



## ***Contact us***



***www.glmgroup.com***



***d.bautista@glmgroup.com***



***+52 2223243317***



## Appendix: Stamping Process

Raw Material-  
Product in Process



Product in Process-  
Finished Product





## Appendix: Hanger Process

Raw Material-  
Product in Process

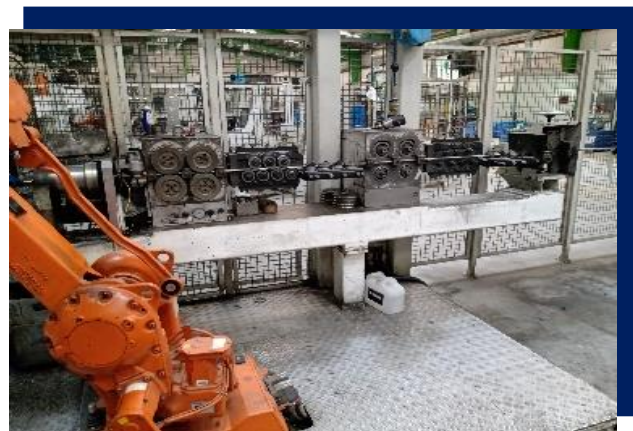

Product in Process-  
Finished Product





## Appendix: Welding Process

Raw Material-Product  
in Process



Product in Process-  
Finished Product





**COMPONENTS**MEXICO  
DIVISION

***ONLY THE BEST DONE BY THE BEST TEAM***



***Grazie***

***Gracias***

**GLM**

***Danke***

***Thank you***