



Racking Systems



About Us

We are a highly qualified company with experience in planning and executing material handling systems.

Our main effort is to reduce costs and increase our customers productivity.

More than 30 years creating industrial rack solutions for all types of storage, meeting the highest quality standards.



Some of our
CLIENTS



DELPHI



FEMSA



TEXTRON



P&G

OUR HISTORY IN

Numbers



We are
backed by

35

years of
experience



2

Manufacturing
Plants



More than

1,600,000

Pallet
Positions
installed

Types Of Racks

There are many different types of pallet racking configurations that can be selected by end users depending on their storage needs. They range from low density selective rack all the way to high-density pushback, drive in, and pallet flow systems. Each configuration has advantages and disadvantages.





Selective Pallet Rack

Single selective pallet rack is the most common style of rack system. It is readily available and provides access to every pallet.

It is the best solution if you have a wide variety of products



Low cost per pallet

Simple stock rotation achieved.



Versatile

Provides access to every pallet.



Pallet-Flow Systems

Widely used in industry that requires a high turnover (food, chemical, automotive, etc), Provides large storage capacity by reducing aisles.



(FIFO) which allows a better control of inventories.

Reduces 75% of the maneuvers of displacement.



Allows a greater number of fronts

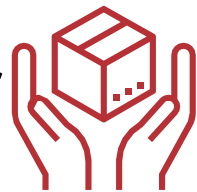

Large Storage Capacity

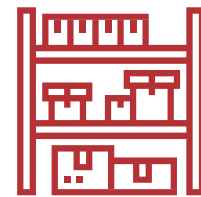

A Series Gravity Rollers

Dimensions

The dimensions of the gravity roller depend on the width of the installation. In the case of a request or order, we need you to provide us with the effective width between the profiles. Sufficient axial play must be taken into account.

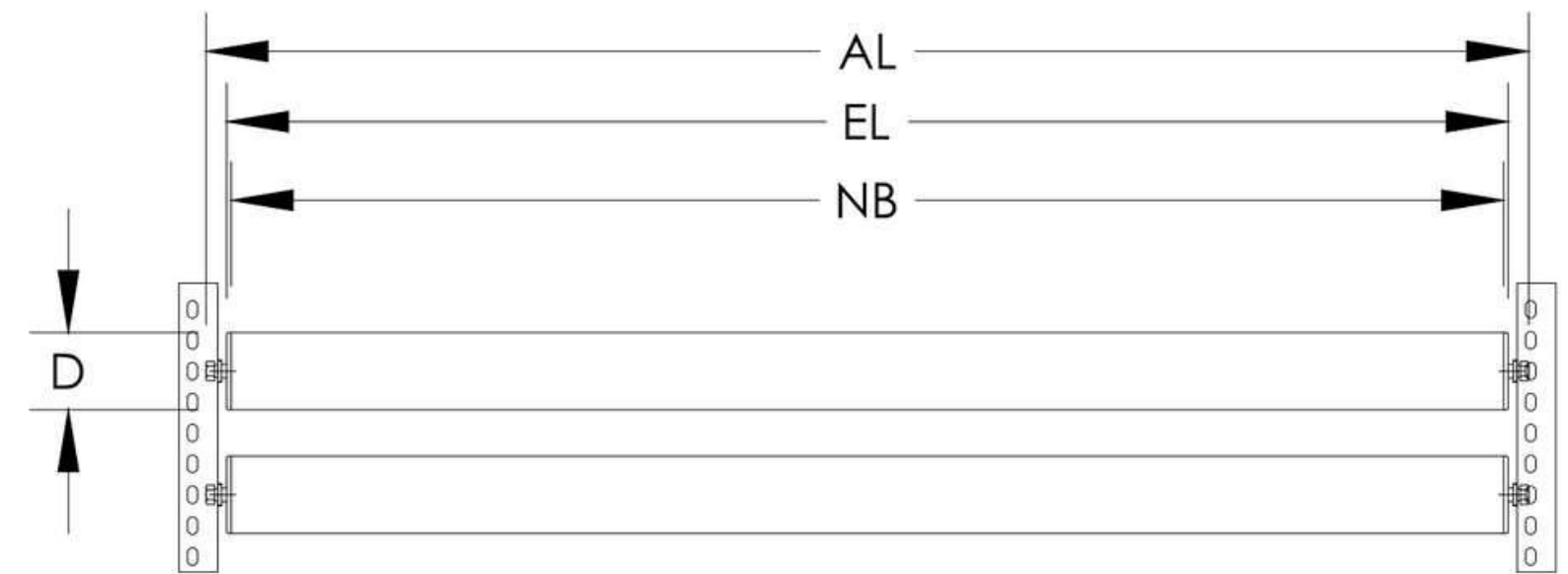

The useful width (NB) is also decisive.

NB = Effective Width

EL = Installation length, effective width between side profiles

RO = Tube dimension without fittings



A Series Gravity Rollers

Diameters and Materials

Available tube diameters and thicknesses are: 2.5" ga. 14-16, 1.9" ga. 14-16, 1 3/8" ga. 14-16. Respective tube types are available in galvanized steel and black steel.

Aplication

The Lifandi Group A Series rollers are for light, medium and heavy loads. Its application is universal: for gravity transport of cardboard boxes, plastic boxes, steel containers, ..but also for pallets and other products.

Productive Capacity

Although the capacity can vary according to the size of the roller, taking an average BFR (Between Frames) of 48" 8,000 rollers per shift can be manufactured.

Variations

The A series impresses with its variety since it can be adjusted to the dimensions according to the load or application needs, in the same way its flexibility thanks to the shaft that it can be used in almost any work environment.

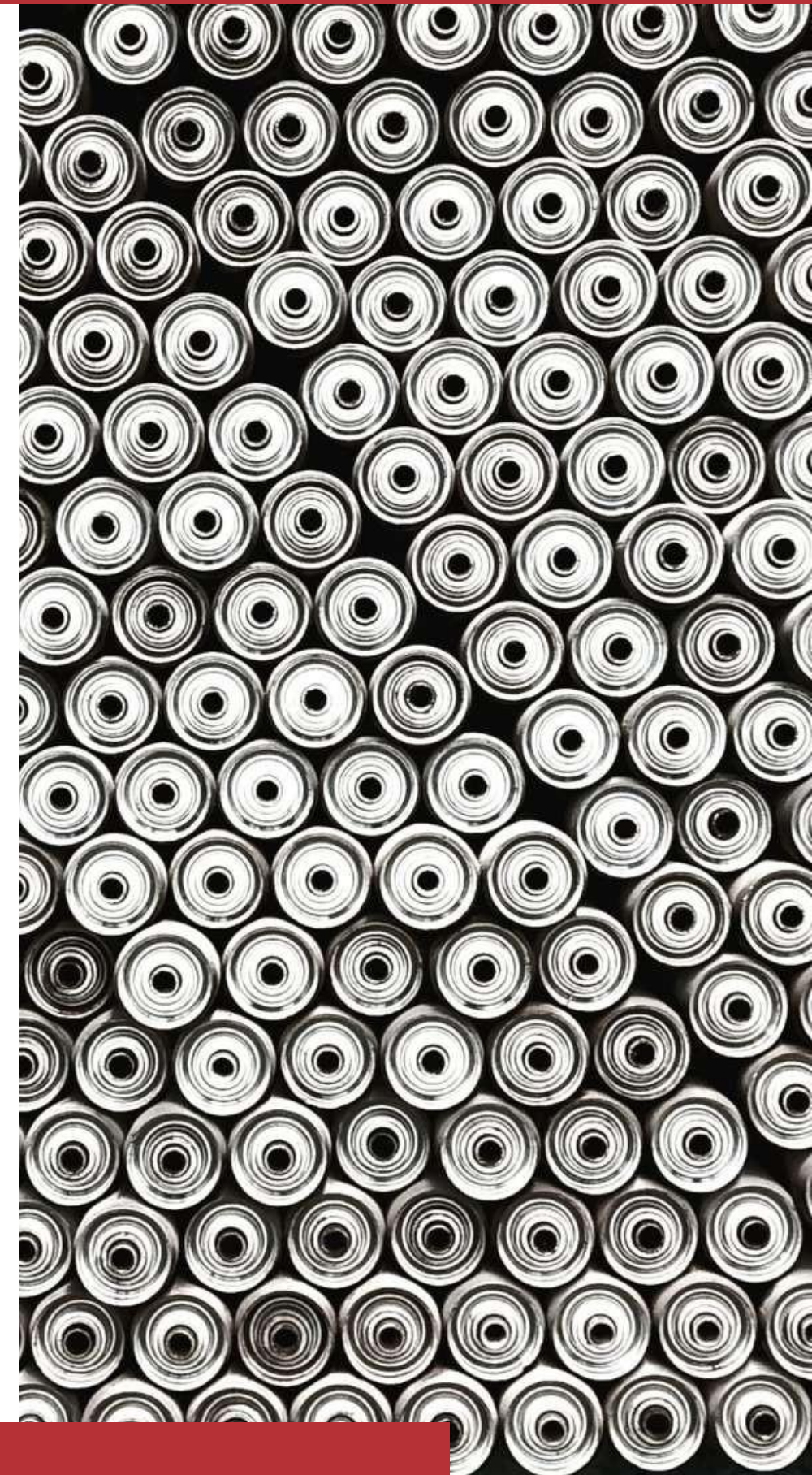

Drive-In System

The Drive in Racking System is a high density storage solution that maximizes available space and height in the warehouse by reducing the forklift operating aisles.

It is the optimal pallet storage system when you need to store homogeneous products with a large number of pallets of the same reference.



Low Cost

LIFO
High Volume

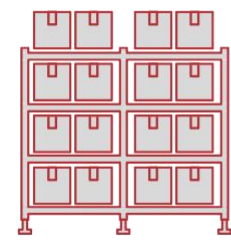

Reduces
aisles

High Volume
Storage

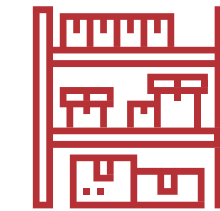



Picking System

Modular picking systems can improve warehouse automation with their ability to concentrate and manage, a large variety of product in high volumes. Picking modules are typically multi-level racking structures with conveyor running through them to move products from the picking areas to the shipping areas.



Increase storage
using warehouse
height

Different SKU's
Medium to high
rotation

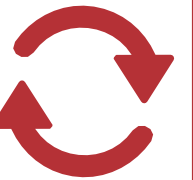

Optimal for heavy
products

Flexible

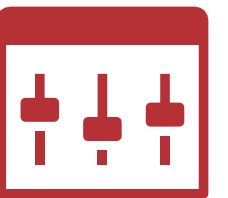



Self Supported System

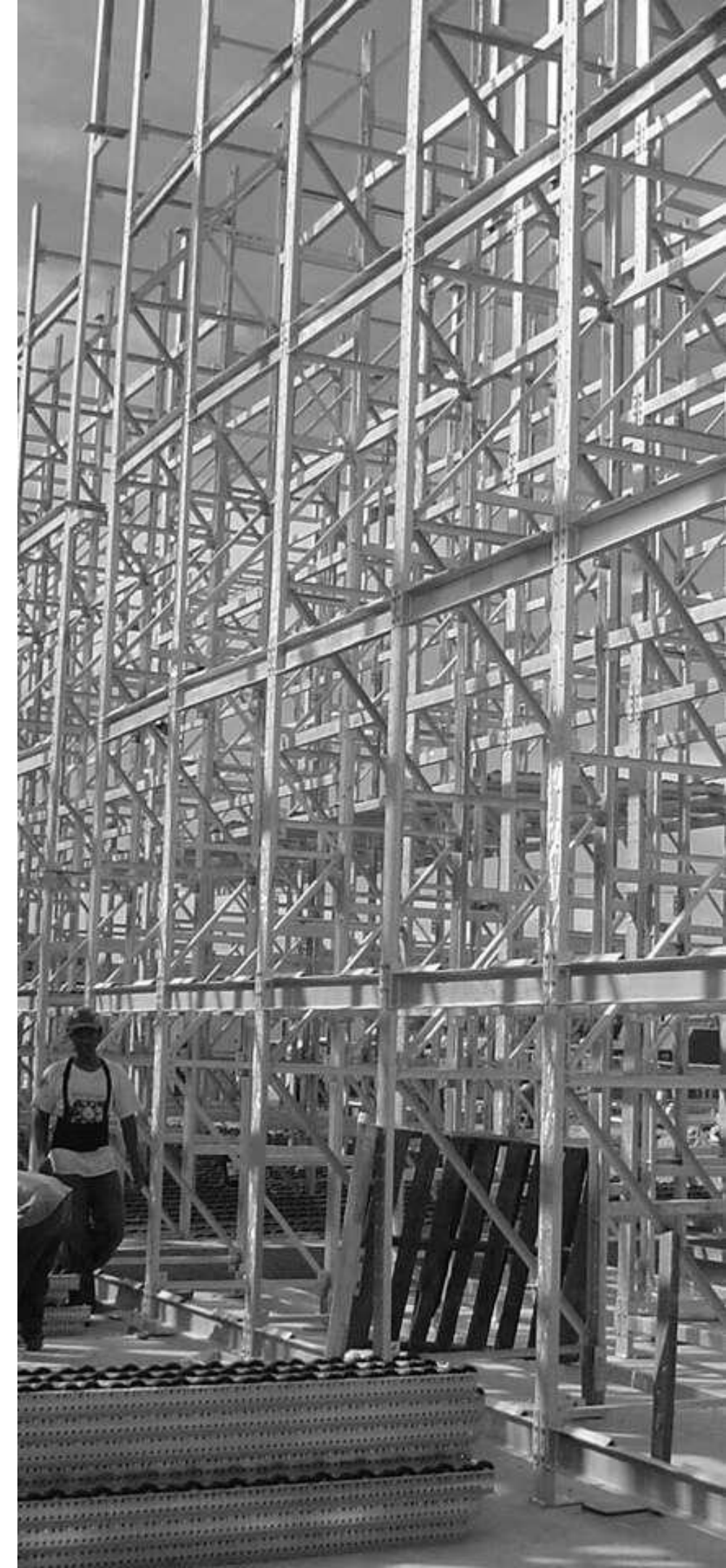

A self-supporting system is a system that integrates the shelf as a supporting structure of the whole construction.

All pallet racking storage systems (be they conventional, drive-in, dynamic, etc.) can be converted into self-supporting systems by adding the appropriate elements to support walls and roof, as well as all the rest of the installations and accessories required for the correct operation of the construction.

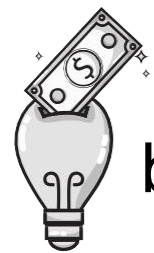

No need for prior building construction

Large storage capacity at high altitude

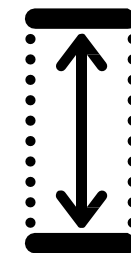

Execution time and cost maximisation

Easy to grow and adapt to new needs



Mezzanine

Mezzanine Floors can double and even triple surface area, increasing the usable surface in height by one or two levels inside a warehouse.

They are independent structures, easy to assemble and adaptable to any space where the flooring can be made of different materials such as wood or grating.



You can add complementary elevators



Optimize the vertical space of a warehouse

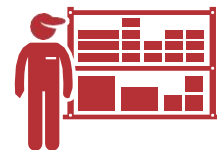

Create additional storage spaces in an already existing installation



Perfect for non pallet products

Conveyors

Pallet Conveyors feature low maintenance chains and efficient power systems that move pallets with minimal human intervention.

Space- and energy-saving solution for the high-throughput handling of pallets.

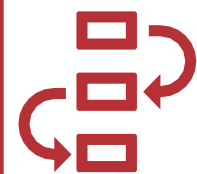

Movement of
loads of any size



Increase security
and prevent
human error

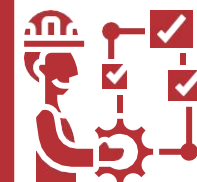

Increase
productivity

Medium Duty Storage Shelving

A single shelf can support up to 800 pounds, while the complete unit can hold up to 4,000 pounds (when evenly distributed and on a level surface), we can manufacture also depending on the load capacity requirements.

Slotted Angle shelving covers all storage requirements, ranging from complete requirement plans to the most immediate. Totally dismountable, the shelves can be modified or expanded both vertically in height, and horizontally in length. An ideal system for the manual storage of both light loads and even relatively heavy ones.

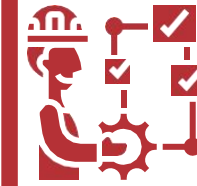

High Weight Capacity



Durable Design

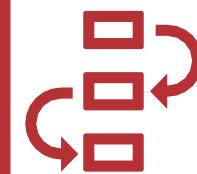

Versatile Use

Pallet Converter

ADVANTAGE

They are collapsible and stackable.

100% product mobility.

Up to 5 pallets can be stacked.

Allows you to generate storage blocks.

The rack is adaptable both in height and length, it can be used in warehouses adaptable for different products in medium loads, taking advantage of height of the warehouse and avoiding aisles.

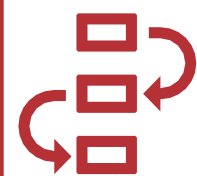

Movement of
loads of any size



Increase security
and prevent
human error

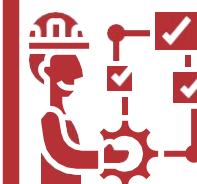

Increase
productivity

Basic Components

ID Component

1 BEAM

2 UPRIGHT FRAME

3 DIAGONAL BRACE

4 HORIZONTAL BRACE

5 RACK DECK

6 COLUMN PROTECTOR

7 RIGID ROW SPACER

8 ROW PROTECTION

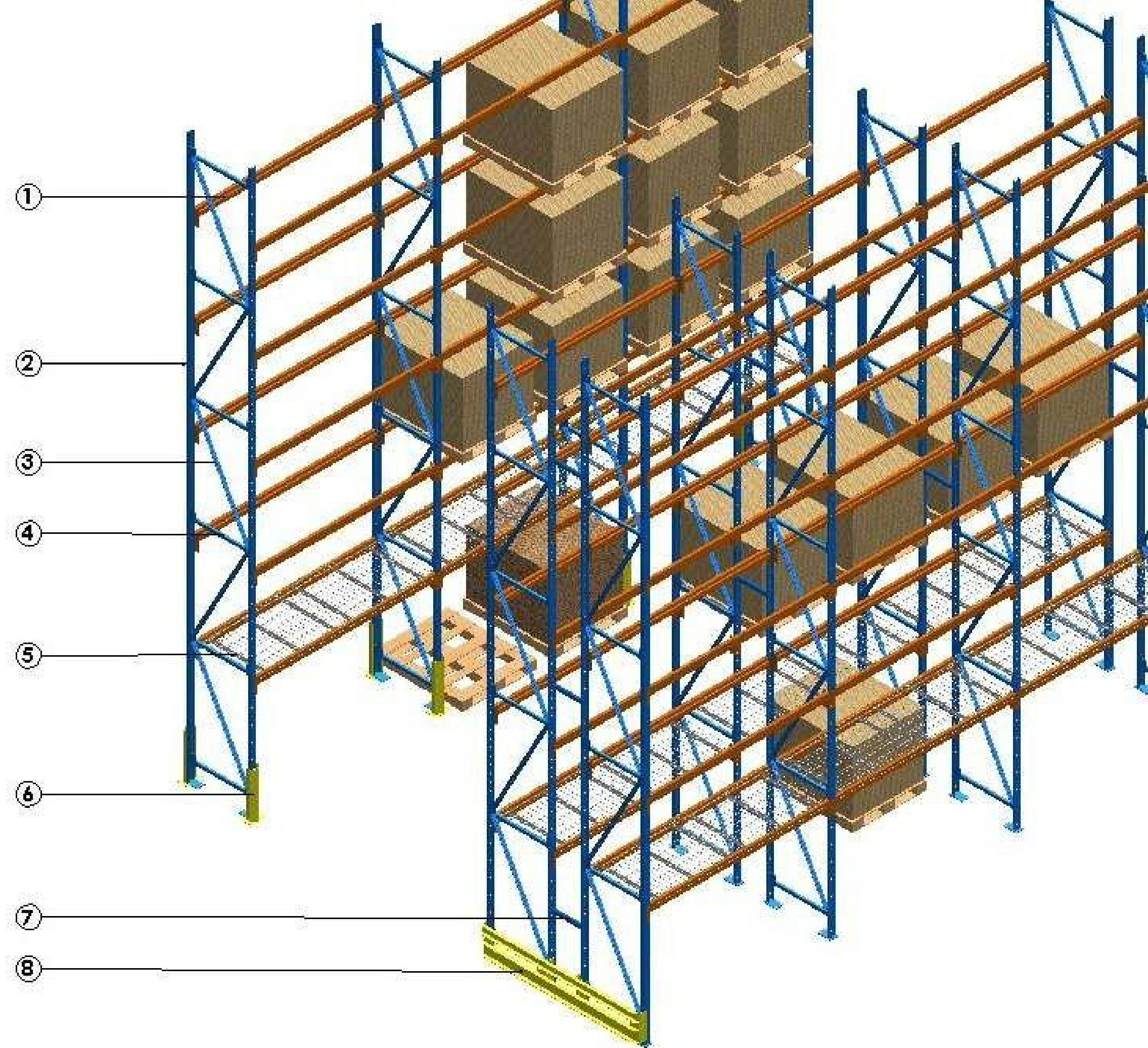

Upright Capacity Chart (Lbs)

We can manufacture Uprights compatible with King Steel, Interlake, Frazier, Penco Racks, Mecalux, Schaefer Racks.

Any other brand that is not included in this list, the product can be developed for manufacture.

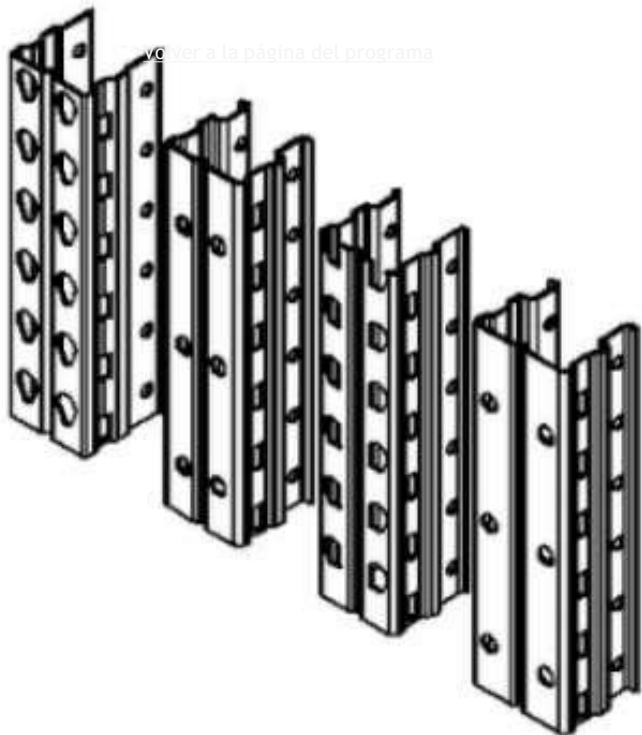
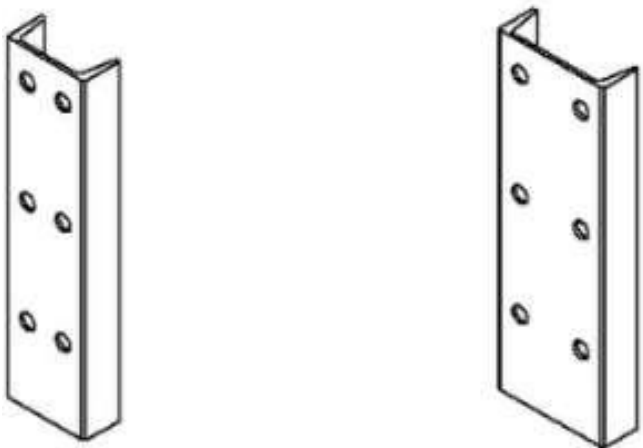

UPRIGHT FRAME CAPACITY

VERTICAL BEAMS SPACING		
48"		
60"		
72"		
84"		
96"		
108"		

BOLTED FRAME CAPACITIES (Lbs)

VERTICAL BEAMS SPACING	75 x 75 mm	90 mm x75 mm
42"		
48"		
54"		
60"		
72"		
84"		
96"		
108"		

Beams

We can manufacture beams compatible with King Steel, Interlake, Frazier, Penco Racks, Mecalux, Schaefer Racks.

Any other brand that is not included in this list, the product can be developed for manufacture.

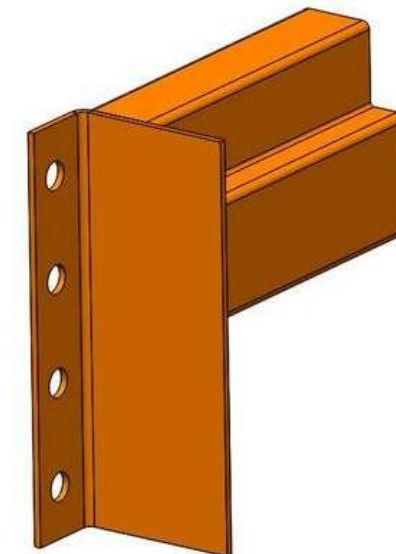
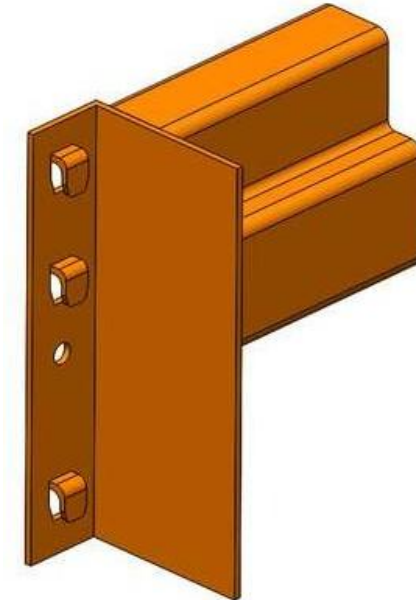
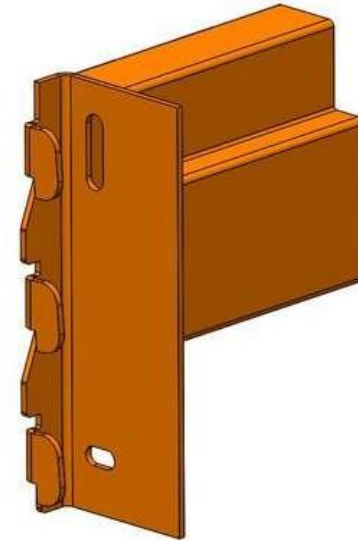
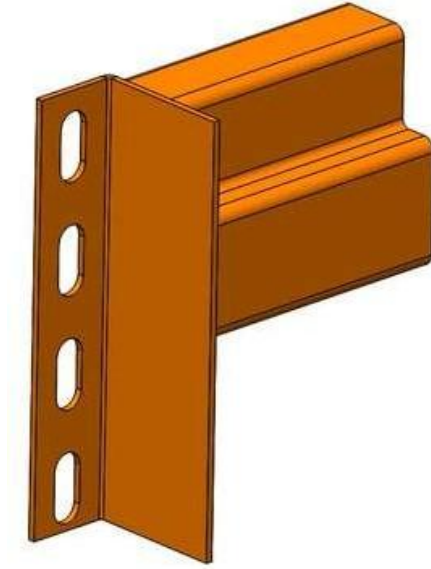
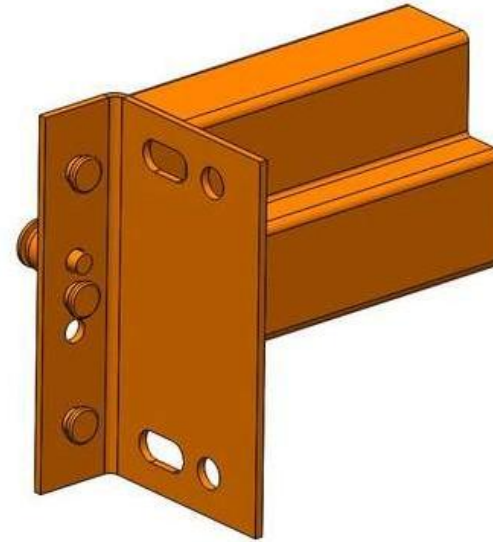

Beam Capacity Chart

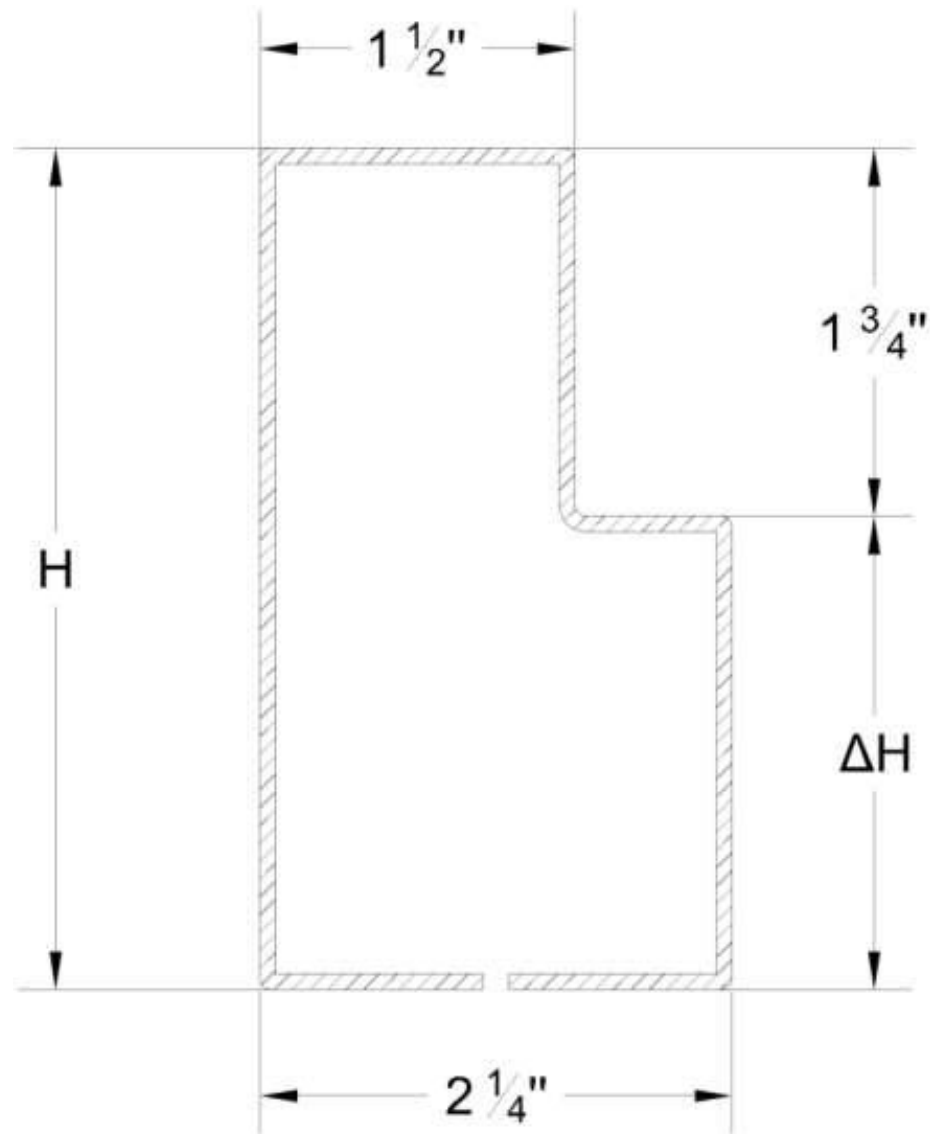

BEAM CAPACITIES (Lbs per pair)							
BEAM LENGHT	3"	3 1/2"	4"	4 1/2"	5"	5 1/2"	6"
48"	7,140	8,970	10,960	13,120	15,370	17,780	20,330
54"	6,340	7,970	9,740	11,670	13,660	15,800	18,070
60"	5,710	7,170	8,770	10,500	12,300	14,220	16,260
84"	4,040	5,120	6,260	7,500	8,780	10,160	11,620
90"	3,520	4,780	5,850	7,000	8,200	9,480	10,840
92"	3,380	4,630	5,720	6,850	8,030	9,280	10,620
96"	3,090	4,480	5,480	6,560	7,690	8,890	10,170
102"	2,740	3,970	5,160	6,180	7,230	8,370	9,570
108"	2,450	3,540	4,870	5,830	6,830	7,900	9,040
114"	2,190	3,170	4,390	5,530	6,470	7,490	8,560
120"	1,960	2,870	3,970	5,250	6,150	7,110	8,130
132"	1,640	2,370	3,280	4,390	5,590	6,460	7,390
138"	1,500	2,170	3,000	4,020	5,200	6,180	7,070
144"	1,370	1,990	2,760	3,690	4,780	5,930	5,780

Contact Us

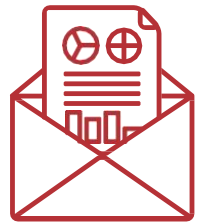

EMAIL

j.guerrero@grupolifandi.com.mx



TELEPHONE

+52 (614) 443-4059 Cel.+52(614) 219-0094

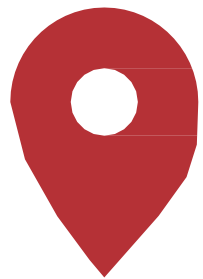

PLANT LOCATION

Bld. Juan Pablo II #8101, Chihuahua, Chih.

